

RESOLUTION NO. R-2018-33

A RESOLUTION OF THE CITY COUNCIL OF THE CITY OF BASTROP, TEXAS APPROVING A MUNICIPAL MAINTENANCE AGREEMENT BETWEEN THE CITY OF BASTROP AND THE TEXAS DEPARTMENT OF TRANSPORTATION; ATTACHED AS EXHIBIT A; AND AUTHORIZING THE CITY MANAGER TO EXECUTE ALL NECESSARY DOCUMENTS; AND ESTABLISHING AN EFFECTIVE DATE.

WHEREAS, The City Council has appointed the City Manager as the Chief Administrative Officer of the City; and

WHEREAS, The City Manager is responsible for the proper administration of all affairs of the City; and

WHEREAS, The City of Bastrop has an interest in maintaining State Highways within and through the City of Bastrop and Bastrop County; and

WHEREAS, The City of Bastrop originally entered into a Municipal Maintenance Agreement with the Texas Department of Transportation in 2000; and

WHEREAS, The Municipal Maintenance Agreement includes language detailing what Highway frontage roads, etc., the City of Bastrop will be responsible for mowing and landscaping; and

WHEREAS, The City of Bastrop has recognized the need for an updated Municipal Maintenance Agreement with the Texas Department of Transportation; and

WHEREAS, Pursuant to Chapter 311 of the Transportation Code gives the City of Bastrop exclusive dominion, control and jurisdiction over and under the public streets within its corporate limits and authorizes the City to enter agreements with the State to fix responsibilities for maintenance, control, supervision, and regulation of State highways within and through its corporate limits; and

WHEREAS, the City Council finds that a very significant public interest is served by the completion of a Municipal Maintenance Agreement.

NOW, THEREFORE, BE IT RESOLVED BY THE CITY COUNCIL OF THE CITY OF BASTROP, TEXAS:

Section 1: That the City Manager is hereby authorized to execute a Municipal Maintenance Agreement between the City of Bastrop and the Texas Department of Transportation. (Exhibit A)

Section 2: All orders, ordinances, and resolutions, or parts thereof, which are in conflict or inconsistent with any provision of this Resolution are hereby repealed to the extent of such conflict, and the provisions of this Resolution shall be and remain controlling as to the matters resolved herein.

Section 3: That this Resolution shall take effect immediately upon its passage, and it is so resolved.

DULY RESOLVED AND ADOPTED by the City Council of the City of Bastrop this 12th day of June, 2018.

APPROVED:



Connie B. Schroeder, Mayor

ATTEST:



Ann Franklin, City Secretary

APPROVED AS TO FORM:



Alan Bojorquez, City Attorney



MUNICIPAL MAINTENANCE AGREEMENT

STATE OF TEXAS §

COUNTY OF TRAVIS §

THIS AGREEMENT made this 12th day of June 20 18, by and between the State of Texas, hereinafter referred to as the "State," party of the first part, and the City of BASTROP, TX (population 7,394, 2010, latest Federal Census) acting by and through its duly authorized officers, hereinafter called the "City," party of the second part.

WITNESSETH

WHEREAS, Chapter 311 of the Transportation Code gives the City exclusive dominion, control, and jurisdiction over and under the public streets within its corporate limits and authorizes the City to enter agreements with the State to fix responsibilities for maintenance, control, supervision, and regulation of State highways within and through its corporate limits; and

WHEREAS, Section 221.002 of the Transportation Code authorizes the State, at its discretion, to enter agreements with cities to fix responsibilities for maintenance, control, supervision, and regulation of State highways within and through the corporate limits of such cities; and

WHEREAS, the Executive Director, acting for and in behalf of the Texas Transportation Commission, has made it known to the City that the State will assist the City in the maintenance and operation of State highways within such City, conditioned that the City will enter into agreements with the State for the purpose of determining the responsibilities of the parties thereto; and

WHEREAS, the City has requested the State to assist in the maintenance and operation of State highways within such City:

AGREEMENT

NOW, THEREFORE, in consideration of the premises and of the mutual covenants and agreements of the parties hereto to be by them respectively kept and performed, it is agreed as follows:

For this agreement, the use of the words "State Highway" shall be construed to mean all numbered highways that are part of the State's Highway System.

COVERAGE

1. This agreement is intended to cover and provide for State participation in the maintenance and operation of the following classifications of State Highways within the City:
 - A. Non-Controlled Access highways or portions thereof which are described and/or graphically shown as "State Maintained and Operated" highways in Exhibit "A," which is attached hereto and made a part hereof.
 - B. All State highways or portions thereof which have been designated by the Texas Transportation Commission or maintained and operated as Controlled Access Highways and which are described and/or graphically shown in Exhibit "B," which is attached hereto and made a part hereof.
2. In the event that the present system of State highways within the City is changed by cancellation, modified routing, or new routes, the State will terminate maintenance and operation and this agreement will become null and void on those portions of the highways which are no longer on the State Highway System; and the full effect and all conditions of this agreement will apply to the changed highways or new highways on the State Highway System within the City; and they shall be classified as "State Maintained and Operated" under paragraph 1 above, unless the execution of a new agreement on the changed or new portions of the highways is requested by either the City or the State.
3. Exhibits that are a part of this agreement may be changed with both parties' written concurrence. Additional exhibits may also be added with both parties' written concurrence.

GENERAL CONDITIONS

1. The City authorizes the State to maintain and operate the State highways covered by this agreement in the manner set out herein.
2. This agreement is between the State and the City only. No person or entity may claim third party beneficiary status under this contract or any of its provisions, nor may any non-party sue for personal injuries or property damage under this contract.
3. This agreement is for the purpose of defining the authority and responsibility of both parties for maintenance and operation of State highways through the City. This agreement shall supplement any special agreements between the State and the City for the maintenance, operation, and/or construction of the State highways covered herein, and this agreement shall supersede any existing Municipal Maintenance Agreements.
4. Traffic regulations, including speed limits, will be established only after traffic and engineering studies have been completed by the State and/or City and approved by the State.
5. The State will erect and maintain all traffic signs and associated pavement markings necessary to regulate, warn, and guide traffic on State highways within the State right-of-way except as mentioned in this paragraph and elsewhere in this agreement. At the intersections of off-system approaches to State highways, the City shall install and maintain all stop signs, yield signs, and one-way signs and any necessary stop or yield bars and pedestrian crosswalks outside the main lanes or outside the frontage roads, if such exist. The City shall install and maintain all street name signs except for those mounted on State maintained traffic signal poles or arms or special advance street name signs on State right-of-way. All new signs installed by the City on State right-of-way shall meet or exceed the latest State breakaway standards and be in accordance with the *Texas Manual on Uniform Traffic Control Devices*, latest edition and revision. All existing signs shall be upgraded on a maintenance replacement basis to meet these requirements.
6. Subject to approval by the State, any State highway lighting system may be installed by the City provided the City shall pay or otherwise provide for all cost of installation, maintenance, and operation except in those installations specifically covered by separate agreements between the City and State.



when having the appropriate resources available may

7. The City shall enforce the State laws governing the movement of loads which exceed the legal limits for weight, length, height, or width as prescribed by Chapters 621, 622, and 623 of the Transportation Code for public highways outside corporate limits of cities. The City shall also, by ordinance/resolution and enforcement, prescribe and enforce lower weight limits when mutually agreed by the City and the State that such restrictions are needed to avoid damage to the highway and/or for traffic safety.
8. The City shall prevent future encroachments within the right-of-way of the State highways and assist in removal of any present encroachments when requested by the State except where specifically authorized by separate agreement; and prohibit the planting of trees or shrubbery or the creation or construction of any other obstruction within the right-of-way without prior approval in writing from the State.
9. Traffic control devices such as signs, traffic signals, and pavement markings, with respect to type of device, points of installation and necessity, will be determined by traffic and engineering studies. The City shall not install, maintain, or permit the installation of any type of traffic control device which will affect or influence the use of State highways unless approved in writing by the State. Traffic control devices installed prior to the date of this agreement are hereby made subject to the terms of this agreement and the City agrees to the removal of such devices which affect or influence the use of State highways unless their continued use is approved in writing by the State. It is understood that basic approval for future installations of traffic control signals by the State or as a joint project with the City, will be indicated by the proper City official's signature on the title sheet of the plans. Both parties should retain a copy of the signed title sheet or a letter signed by both parties acknowledging which signalized intersections are covered by this agreement. Any special requirements not covered within this agreement will be covered under a separate agreement.
10. New construction of sidewalks, ramps or other accessibility related items shall comply with current ADA standards. The city is responsible for the maintenance of these items.
11. If the City has a driveway permit process that has been submitted to and approved by the State, the City will issue permits for access driveways on State highway routes and will assure the grantee's conformance, for proper installation and maintenance of access driveway facilities, with either a Local Access Management Plan that the City has adopted by ordinance and submitted to the State or, if the City has not adopted by ordinance and submitted to the State a Local Access Management Plan, the State's "Regulations for Access Driveways to State Highways" and the State's Access Management Manual. If the City does not have an approved city-wide driveway permit process, the State will issue access driveway permits on State highway routes in accordance with the City's Local Access Management Plan, adopted by city ordinance and submitted to the State or, if the City has not adopted by ordinance and submitted a Local Access Management Plan, the State's "Regulations for Access Driveways to State Highways" and the State's Access Management Manual.
12. The use of unused right-of-way and areas beneath structures will be determined by a separate agreement

NON-CONTROLLED ACCESS HIGHWAYS

The following specific conditions and responsibilities shall be applicable to non-controlled access State highways in addition to the "General Conditions" contained herein above. Non-controlled access State highways or portions thereof covered by this section are those listed and/or graphically shown in Exhibit "A."

State's Responsibilities (Non-Controlled Access)

1. Maintain the traveled surface and foundation beneath such traveled surface necessary for the proper support of same under vehicular loads encountered and maintain the shoulders.
2. Assist in mowing and litter pickup to supplement City resources when requested by the City and if State resources are available.
3. Assist in sweeping and otherwise cleaning the pavement to supplement City resources when requested by the City and if State resources are available.

4. Assist in snow and ice control to supplement City resources when requested by the City and if State resources are available.
5. Maintain drainage facilities within the limits of the right-of-way and State drainage easements. This does not relieve the City of its responsibility for drainage of the State highway facility within its corporate limits.
6. Install, maintain, and operate, when required, normal regulatory, warning and guide signs and normal markings (except as provided under "General Conditions" in paragraph 5). In cities with less than 50,000 population, this also includes school safety devices, school crosswalks, and crosswalks installed in conjunction with pedestrian signal heads. This does not include other pedestrian crosswalks. Any other traffic striping desired by the City may be placed and maintained by the City subject to written State approval.
7. Install, operate, and maintain traffic signals in cities with less than 50,000 population.
8. In cities equal to or greater than 50,000 population, the State may provide for installation of traffic signals when the installation is financed in whole or in part with federal-aid funds if the City agrees to enter into an agreement setting forth the responsibilities of each party.

City's Responsibilities (Non-Controlled Access)

1. Prohibit angle parking, except upon written approval by the State after traffic and engineering studies have been conducted to determine if the State highway is of sufficient width to permit angle parking without interfering with the free and safe movement of traffic.
2. Install and maintain all parking restriction signs, pedestrian crosswalks [except as provided in paragraph 6 under "State's Responsibilities (Non-Controlled Access)"], parking stripes and special guide signs when agreed to in writing by the State. Cities greater than or equal to 50,000 population will also install, operate, and maintain all school safety devices and school crosswalks.
3. Signing and marking of intersecting city streets with State highways will be the full responsibility of the City (except as provided under "General Conditions" in paragraph 5).
4. Require installations, repairs, removals or adjustments of publicly or privately owned utilities or services to be performed in accordance with Texas Department of Transportation specifications and subject to approval of the State in writing.
5. Retain all functions and responsibilities for maintenance and operations which are not specifically described as the responsibility of the State. The assistance by the State in maintenance of drainage facilities does not relieve the City of its responsibility for drainage of the State highway facility within its corporate limits except where participation by the State is specifically covered in a separate agreement between the City and the State.
6. Install, maintain, and operate all traffic signals in cities equal to or greater than 50,000 population. Any variations will be handled by a separate agreement.
7. Perform mowing and litter pickup.
8. Sweep and otherwise clean the pavement.
9. Perform snow and ice control.

CONTROLLED ACCESS HIGHWAYS

The following specific conditions and responsibilities shall be applicable to controlled access highways in addition to the "General Conditions" contained herein above. Controlled access State highways or portions thereof covered by this section are those listed and/or graphically shown in Exhibit "B."



State's Responsibilities (Controlled Access)

1. Maintain the traveled surface of the through lanes, ramps, and frontage roads and foundations beneath such traveled surface necessary for the proper support of same under vehicular loads encountered.
2. Mow and clean up litter within the outermost curbs of the frontage roads or the entire right-of-way width where no frontage roads exist and assist in performing these operations between the right-of-way line and the outermost curb or crown line of the frontage roads in undeveloped areas.
3. Sweep and otherwise clean the through lanes, ramps, separation structures or roadways and frontage roads.
4. Remove snow and control ice on the through lanes and ramps and assist in these operations as the availability of equipment and labor will allow on the frontage roads and grade separation structures or roadways.
5. Except as provided under "General Conditions" in paragraph 5, the State will install and maintain all normal markings and signs, including sign operation if applicable, on the main lanes and frontage roads. This includes school safety devices, school crosswalks and crosswalks installed on frontage roads in conjunction with pedestrian signal heads. It does not include other pedestrian crosswalks.
6. Install, operate and maintain traffic signals at ramps and frontage road intersections unless covered by a separate agreement.
7. Maintain all drainage facilities within the limits of the right-of-way and State drainage easements. This does not relieve the City of its responsibility for drainage of the highway facility within its corporate limits.

City's Responsibilities (Controlled Access)

1. Prohibit, by ordinance or resolution and through enforcement, all parking on frontage roads except when parallel parking on one side is approved by the State in writing. Prohibit all parking on main lanes and ramps and at such other places where such restriction is necessary for satisfactory operation of traffic, by passing and enforcing ordinances/resolutions and taking other appropriate action in addition to full compliance with current laws on parking.
2. When considered necessary and desirable by both the City and the State, the City shall pass and enforce an ordinance/resolution providing for one-way traffic on the frontage roads except as may be otherwise agreed to by separate agreements with the State.
3. Secure or cause to be secured the approval of the State before any utility installation, repair, removal or adjustment is undertaken, crossing over or under the highway facility or entering the right-of-way. In the event of an emergency, it being evident that immediate action is necessary for protection of the public and to minimize property damage and loss of investment, the City, without the necessity of approval by the State, may at its own responsibility and risk make necessary emergency utility repairs, notifying the State of this action as soon as practical.
4. Pass necessary ordinances/resolutions and retain its responsibility for enforcing the control of access to the expressway/freeway facility.
5. Install and maintain all parking restriction signs, pedestrian crosswalks (except as mentioned above in paragraph 5 under "State's Responsibilities") and parking stripes when agreed to by the State in writing. Signing and marking of intersecting city streets to State highways shall be the full responsibility of the City (except as discussed under "General Conditions" in paragraph 5).



TERMINATION

All obligations of the State created herein to maintain and operate the State highways covered by this agreement shall terminate if and when such highways cease to be officially on the State highway system; and further, should either party fail to properly fulfill its obligations as herein outlined, the other party may terminate this agreement upon 30 days written notice. Upon termination, all maintenance and operation duties on non-controlled access State highways shall revert to City responsibilities, in accordance with Chapter 311 of the Texas Transportation Code. The State shall retain all maintenance responsibilities on controlled access State highways in accordance with the provisions of Chapter 203 of the Texas Transportation Code and 23 United States Code Section 116.

Said State assumption of maintenance and operations shall be effective the date of execution of this agreement by the Texas Department of Transportation.

IN WITNESS WHEREOF, the parties have hereunto affixed their signatures, the City of BASTROP, TX
on the 19th day of June, 20 18, and the Texas Department of Transportation, on the _____ day
of _____, 20_____.

ATTEST: [Signature]
CITY OF BASTROP, TX
BY [Signature]
(Title of Signing Official)

THE STATE OF TEXAS
Executed and approved for the Texas Transportation Commission for the purpose and effect of activating and/or carrying out the orders, and established policies or work programs heretofore approved and authorized by the Texas Transportation Commission
BY _____
(District Engineer)
_____ District

The Texas Department of Transportation maintains the information collected through this form. With few exceptions, you are entitled on request to be informed about the information that we collect about you. Under Sections 552.021 and 552.023 of the Government Code, you also are entitled to receive and review this information. Under Section 559.004 of the Government Code, you are also entitled to have us correct information about you that is incorrect. For more information, call 512/416-3048.

NOTE: To be executed in duplicate and supported by Municipal Maintenance Ordinance/Resolution and City Secretary Certificate.

EXHIBIT A

TABLE I
NON-CONTROLLED ACCESS HIGHWAYS
(See Figure A-1)

HWY	Description
SH 21	From State Highway 95 to east Bastrop City limit
SH 95	From State Highway 71 to northern Bastrop City limit
SH 304	From State Highway 71 to southern Bastrop City limit
SL 150	From State Highway 71 west to State Highway 71 east
FM 969	From State Highway 71 to northern Bastrop City limit
RM 20	From State Highway 71 to southern Bastrop City limit

Maintenance Activity/Facility-Type	Responsibility	
	State	City
Traffic control signs and pavement striping/markings, highway routing signs.	X	
All pavement base and surface maintenance, repair, reconstruction, and resurfacing.	X	
Assist with mowing, sweeping, cleaning, and litter control to supplement City resources when requested by the City and if State resources are available.	X	
Assist with snow and ice control to supplement City resources when requested by the City and if State resources are available.	X	
All pedestrian and bicycle assets including pedestrian bridges, pedestrian rail, sidewalks, curb ramps, shared use path, bike lanes, bikeways or trails.		X
Drainage facilities outside of normal highway right-of-way.		X
All duties not specifically delineated as being State's responsibility.		X

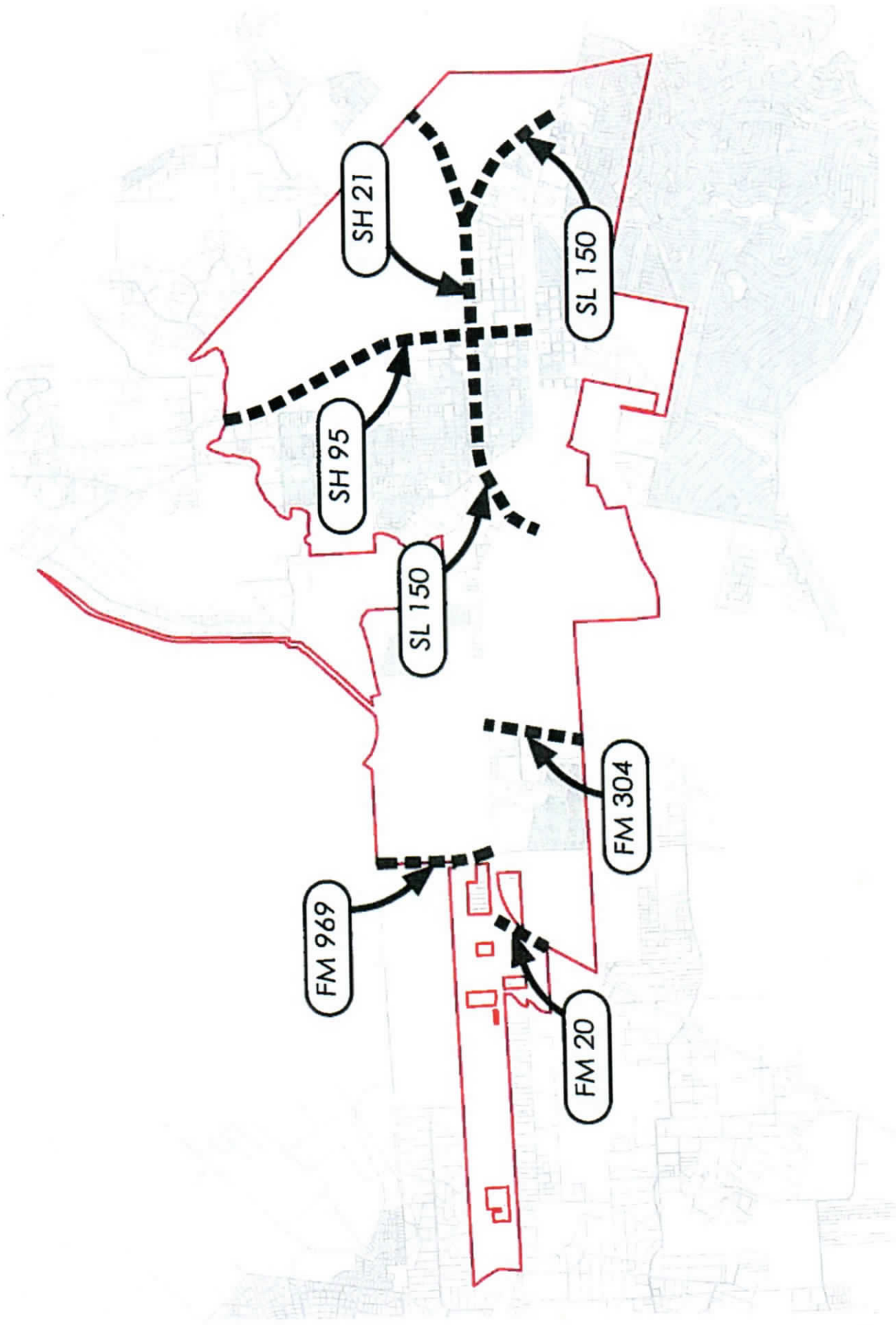

[Handwritten signature]

EXHIBIT B
TABLE II
CONTROLLED ACCESS HIGHWAYS
(See Figure B-1)

SH 71	From east city limit to west city limit		
Maintenance Activity/Facility-Type		Responsibility	
		State	City
1. Main lanes, main lane bridges and entrance/exit ramps:		X	
Normal route markings, directional and destination signs and pavement striping/markings.		X	
All pavement base and surface maintenance, repair, reconstruction, and resurfacing.		X	
Drainage facilities		X	
Snow and ice control		X	
Mowing		X	
Litter and debris control.		X	
2. Frontage roads, median between main lane and frontage road, area between frontage road and right-of-way line:			
Same as above except:			
Assist with mowing and litter/debris control to supplement City resources when requested by the City and if State resources are available.		X	
3. Frontage roads, median between main lane and frontage road, area between frontage road and right-of-way line:			
Mowing and landscaping at intersections			X
State Highway 71 at Loop 150/Tahitian Village			X
State Highway 71 at State Highway 95			X
State Highway 71 at Loop 150/Childress Dr.			X
State Highway 71 at State Highway 304			X
State Highway 71 at Farm to Market 20			X
State Highway 95 at State Highway 21 / Loop 150			X

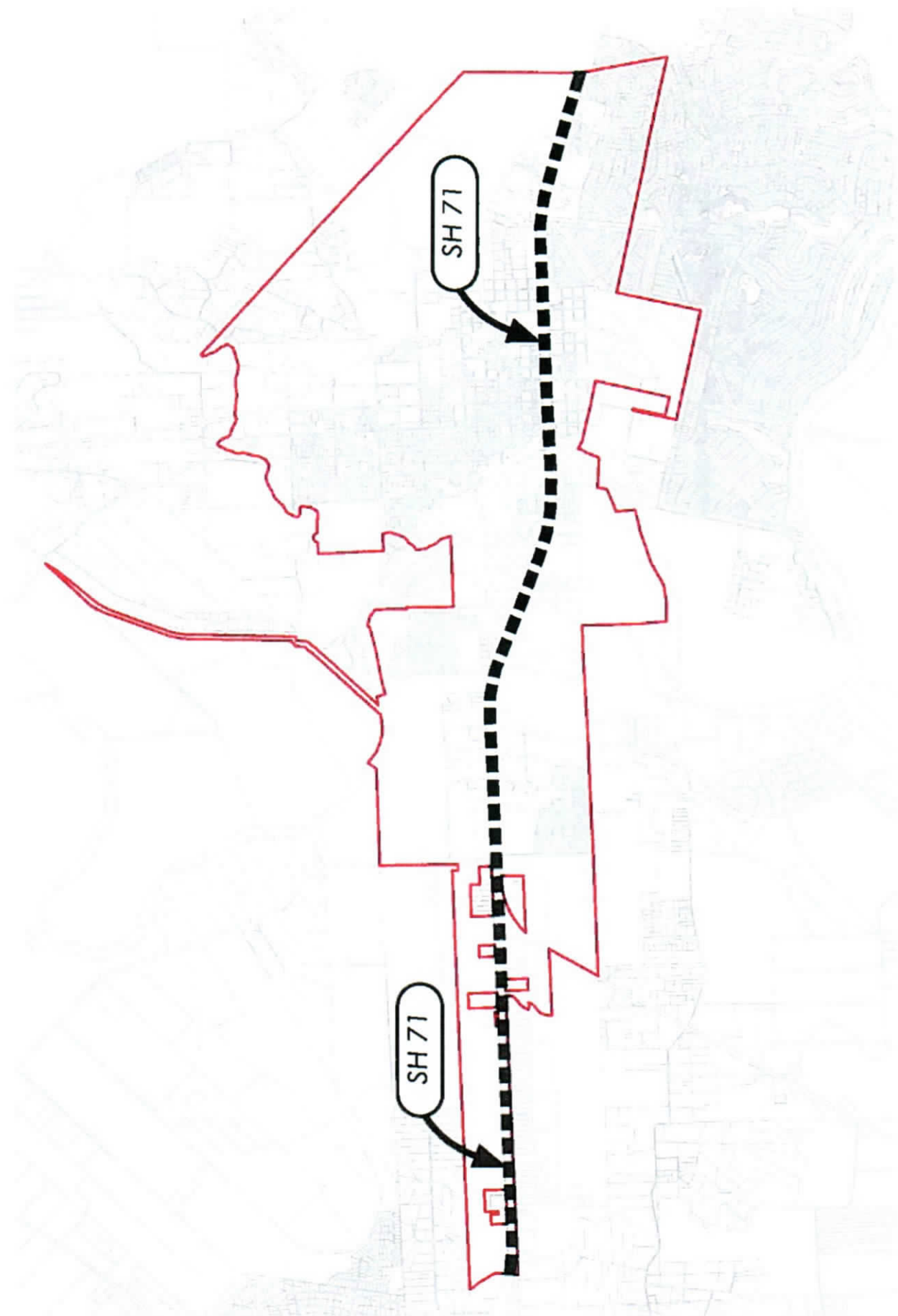

[Handwritten signature]

Signal Agreement

Loop 150 (Chestnut Street) and Pecan Street





P.O. BOX 15426 | AUSTIN, TEXAS 78761-5426 | (512) 832-7000 | WWW.TXDOT.GOV

December 6, 2013

Mike Talbot, City Manager
City of Bastrop
1311 Chestnut Street
Bastrop, Texas 78602

Dear Mr. Talbot:

The Texas Department of Transportation (TxDOT) would like to enter an agreement with the City of Bastrop to modify the signal at the intersection of Loop 150 (Chestnut St.) and Pecan St. We are in the process of upgrading the existing signal design to new mast arm signals. However, limited state right of way at the above intersection requires that we use city right of way along Pecan Street to install signal poles and equipment.

With your concurrence for the use of the right of way, TxDOT will be responsible for the installation, maintenance and operation of these signals, including the relocation of these signals, should that ever be necessary.

The authority to enter this agreement can be found in the Municipal Maintenance Agreement of 2000. This agreement allows the City and State to determine the maintenance responsibilities of each entity. Specifically, it addresses *"Traffic control devices, such as signs, traffic signals ... in respect to type of device, points of installation, and necessity will be fixed by agreement with the State after traffic and Engineering surveys have been made."* See the attached exhibit for the locations and types of devices to be installed within the city's right of way.

By your signature below, the City of Bastrop will allow TxDOT to install and maintain signal equipment within the right of way of Pecan St. at the intersection of Loop 150. After signing each of these duplicate letters please retain one for your files and return the other for our files. You may retain the attached exhibit for your files. Should you have any questions, please contact Wayne Rehnberg, P.E. at (512) 832-7019.

Sincerely,

Greg A. Malatek P.E.
Austin District Engineer

The City of Bastrop agrees to the conditions stated in this letter:

Mike Talbot, City Manager
City of Bastrop

cc: Roy M. Dill, P.E., Bastrop Area Engineer, TxDOT, Austin District
Imelda L. Barrett, P.E., Director of Transportation Operations, TxDOT, Austin District

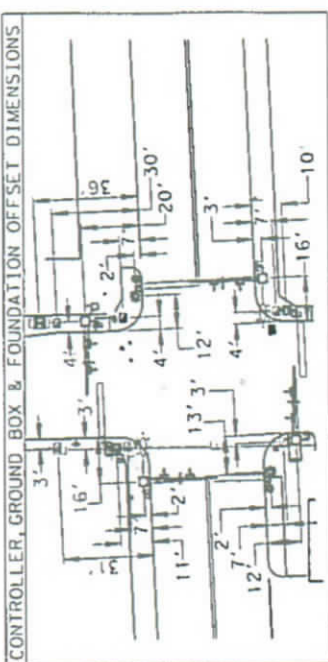

CONTROLLER, GROUND BOX & FOUNDATION OFFSET DIMENSIONS

PROPOSED MAST ARMS	
(E)	INS TRF SIG PL AM(S) 1 ARM (24') (686-2023)
(F)	INS TRF SIG PL AM(S) 1 ARM (24') LUM (686-2025)
(G)	INS TRF SIG PL AM(S) 1 ARM (24') (686-2023)
(H)	INS TRF SIG PL AM(S) 1 ARM (24') LUM (686-2025)
PROPOSED PED POLE LEGEND	
(I)	PED POLE ASSY (687-2001)

INSTALL ELEC SVC TY D (120/240)070(INS)AL(E)SP(0)

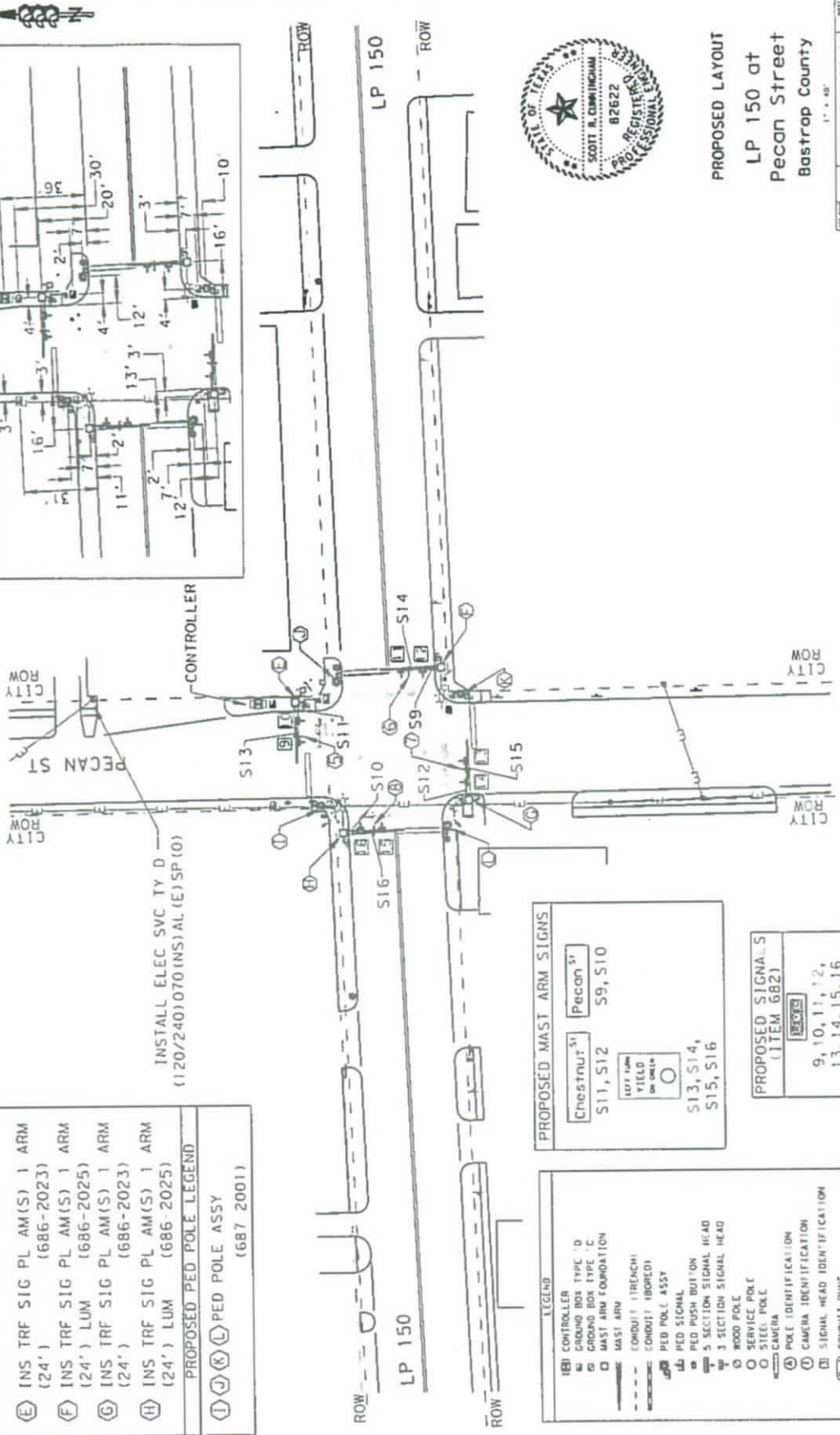

PROPOSED LAYOUT
 LP 150 at
 Pecan Street
 Bastrop County

DATE	STATE	FEDERAL AID PROJECT NO.	POST
11	TX		LP 150
COUNTY	CITY		
BASTROP			



© 2013 by Texas Department of Transportation; all rights reserved

PROPOSED MAST ARM SIGNS	
Chestnut 5'	Pecan 5'
S11, S12	S9, S10
 YIELD ON GREEN	
S13, S14, S15, S16	

PROPOSED SIGNALS (ITEM 682)	
9, 10, 11, 12, 13, 14, 15, 16	

LEGEND	
(E)	CONTROLLER
(G)	GROUND BOX TYPE 'D'
(H)	GROUND BOX TYPE 'C'
(I)	MAST ARM FOUNDATION
(J)	MAST ARM
(K)	CONDUIT (TRENCH)
(L)	CONDUIT (BORED)
(M)	PED POLE ASSY
(N)	PED SIGNAL
(O)	PED PUSH BUTTON
(P)	5 SECTION SIGNAL HEAD
(Q)	3 SECTION SIGNAL HEAD
(R)	WOOD POLE
(S)	SERVICE POLE
(T)	STEEL POLE
(U)	CAMERA
(V)	POLE IDENTIFICATION
(W)	CAMERA IDENTIFICATION
(X)	SIGNAL HEAD IDENTIFICATION
(Y)	CONDUIT RUNS
(Z)	LUMINAIRE
(AA)	ANTENNA

[Handwritten signature]

Project Layout /
Landscaping Layout

State Highway 71 at State Highway 304



MATCHLINE STA. 926+00

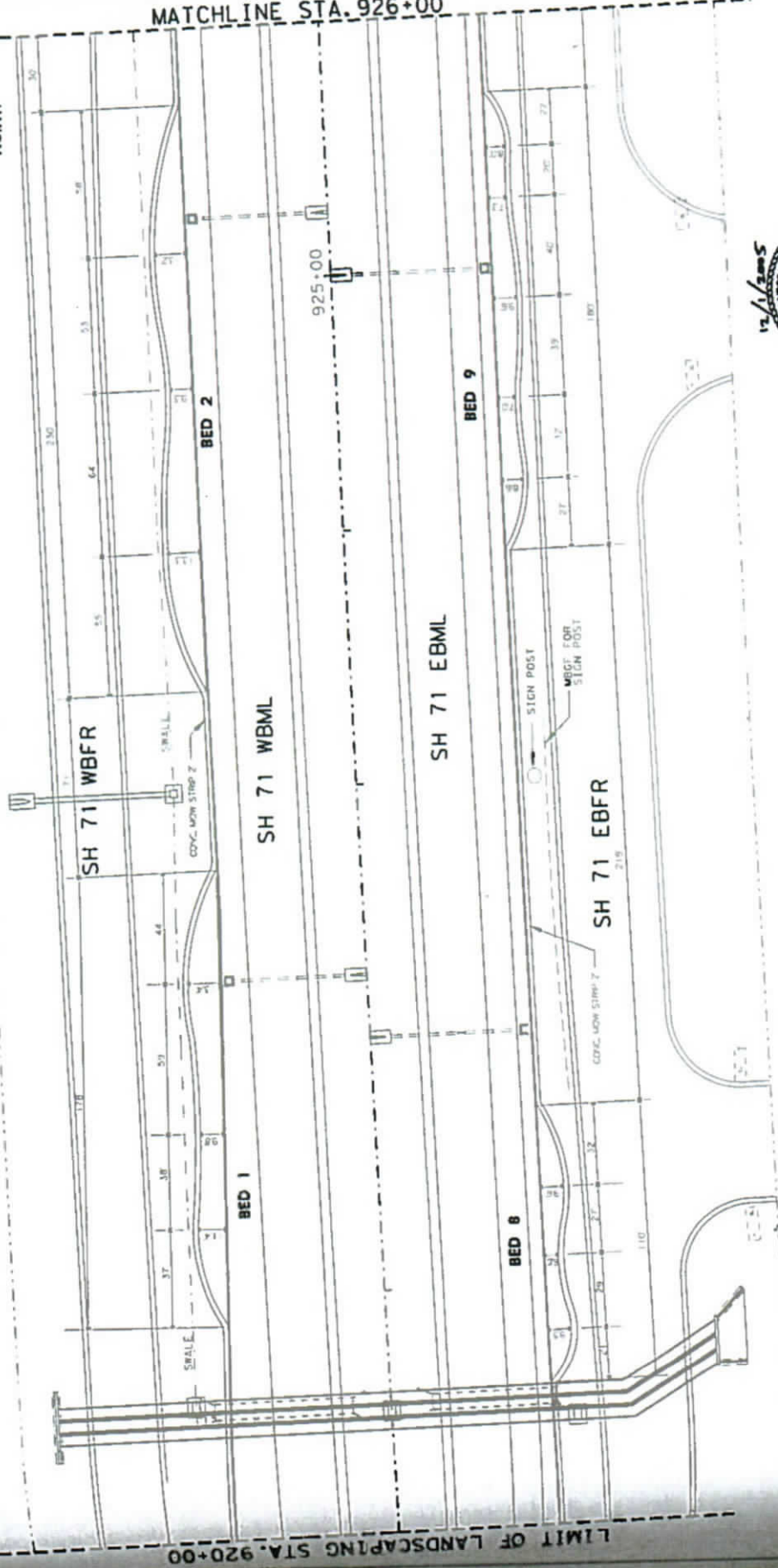
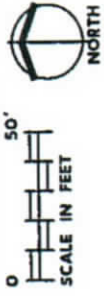

LIMIT OF LANDSCAPING STA. 920+00

BED LAYOUT

12/1/2005

REGISTERED PROFESSIONAL ARCHITECT & SURVEYOR

STATE OF TEXAS

NO. 0265

DATE 04-05-11

PROJECT NO. 114

CLIENT BASTROP

DESIGNER

DRAWN BY

CHECKED BY

DATE



- NOTES:**
1. PLANTING BED AREAS SHALL BE Laid OUT IN SMOOTH CURVES.
 2. PLANTING BED AREAS SHALL BE MADE TO THE INSIDE OF THE LOW STRIP.
 3. CONTRACTOR SHALL MARK BED AREAS FOR ENGINEER'S APPROVAL.
 4. UPON APPROVAL CONTRACTOR SHALL REMOVE EXISTING VEGETATION FROM PLANTING BED AREAS AS DESCRIBED IN THE GENERAL NOTES.
 5. IF BED LAYOUT CONFLICT WITH OTHER ELEMENTS, CONTACT ENGINEER FOR DIRECTION.

[Handwritten signature]

MATCHLINE STA. 932+00



0 50' SCALE IN FEET

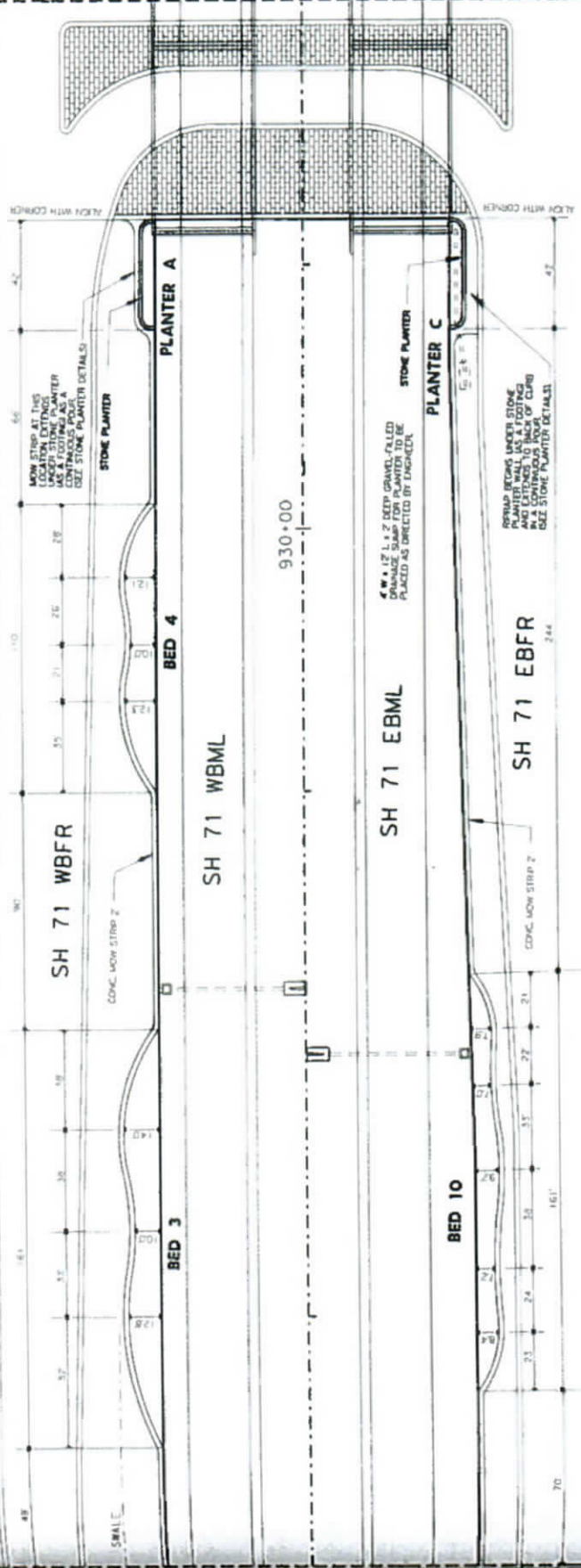

BED LAYOUT SHEET 2 OF 4

PROJECT	118 PROJECT NO.	118
DATE	DATE	
REVISION	DATE	
BY	DATE	
CHECKED	DATE	
DATE	DATE	

- NOTES:**
1. PLANTING BED AREAS SHALL BE Laid OUT IN SMOOTH CURVES.
 2. ALL BED DIMENSIONS ARE MADE TO THE INSIDE OF THE MOW STRIP.
 3. CONTRACTOR SHALL MARK BED AREAS FOR ENGINEERING APPROVAL.
 4. UPON APPROVAL, CONTRACTOR SHALL REMOVE EXISTING VEGETATION FROM PLANTING BED AREAS AS DESCRIBED IN THE GENERAL NOTES.
 5. IF BED LAYOUT CONFLICTS WITH OTHER ELEMENTS, CONTACT ENGINEER FOR DIRECTION.

[Handwritten signature]

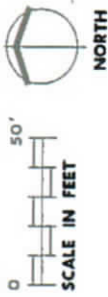

MATCHLINE STA. 938+00

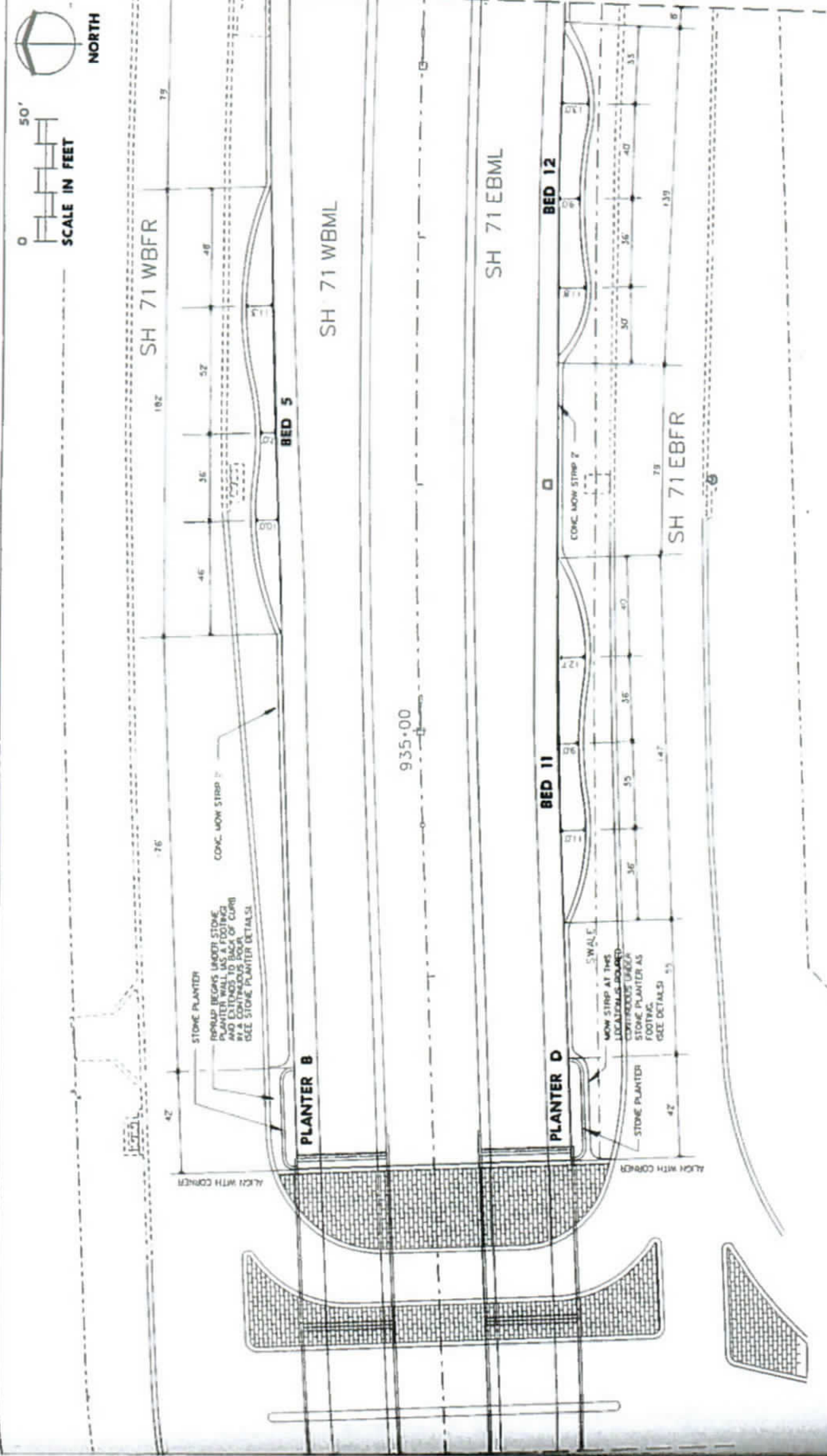

NOTES:

1. PLANTING BED AREAS SHALL BE LAD OUT IN SMOOTH CURVES.
2. ALL BED DIMENSIONS ARE MADE TO THE INSIDE OF THE MOW STRIP.
3. CONTRACTOR SHALL MARK BED AREAS FOR DABREETS APPROVAL.
4. UPON APPROVAL CONTRACTOR SHALL REMOVE EXISTING VEGETATION FROM PLANTING BED AREAS AS DESCRIBED IN THE GENERAL NOTES.
5. IF BED DIMENSIONS CONFLICT WITH OTHER ELEMENTS, CONTACT DABREETS FOR DIRECTION.

BED LAYOUT

Sheet 3 of 4
© 2008 Texas Department of Transportation

NO.	DATE	BY	CHKD.	APP'D.	DESCRIPTION
1	02/25	DA	DA	DA	DESIGN
2	02/25	DA	DA	DA	DESIGN
3	02/25	DA	DA	DA	DESIGN
4	02/25	DA	DA	DA	DESIGN
5	02/25	DA	DA	DA	DESIGN
6	02/25	DA	DA	DA	DESIGN
7	02/25	DA	DA	DA	DESIGN
8	02/25	DA	DA	DA	DESIGN
9	02/25	DA	DA	DA	DESIGN
10	02/25	DA	DA	DA	DESIGN
11	02/25	DA	DA	DA	DESIGN
12	02/25	DA	DA	DA	DESIGN
13	02/25	DA	DA	DA	DESIGN
14	02/25	DA	DA	DA	DESIGN
15	02/25	DA	DA	DA	DESIGN
16	02/25	DA	DA	DA	DESIGN
17	02/25	DA	DA	DA	DESIGN
18	02/25	DA	DA	DA	DESIGN
19	02/25	DA	DA	DA	DESIGN
20	02/25	DA	DA	DA	DESIGN
21	02/25	DA	DA	DA	DESIGN
22	02/25	DA	DA	DA	DESIGN
23	02/25	DA	DA	DA	DESIGN
24	02/25	DA	DA	DA	DESIGN
25	02/25	DA	DA	DA	DESIGN
26	02/25	DA	DA	DA	DESIGN
27	02/25	DA	DA	DA	DESIGN
28	02/25	DA	DA	DA	DESIGN
29	02/25	DA	DA	DA	DESIGN
30	02/25	DA	DA	DA	DESIGN
31	02/25	DA	DA	DA	DESIGN
32	02/25	DA	DA	DA	DESIGN
33	02/25	DA	DA	DA	DESIGN
34	02/25	DA	DA	DA	DESIGN
35	02/25	DA	DA	DA	DESIGN
36	02/25	DA	DA	DA	DESIGN
37	02/25	DA	DA	DA	DESIGN
38	02/25	DA	DA	DA	DESIGN
39	02/25	DA	DA	DA	DESIGN
40	02/25	DA	DA	DA	DESIGN
41	02/25	DA	DA	DA	DESIGN
42	02/25	DA	DA	DA	DESIGN
43	02/25	DA	DA	DA	DESIGN
44	02/25	DA	DA	DA	DESIGN
45	02/25	DA	DA	DA	DESIGN
46	02/25	DA	DA	DA	DESIGN
47	02/25	DA	DA	DA	DESIGN
48	02/25	DA	DA	DA	DESIGN
49	02/25	DA	DA	DA	DESIGN
50	02/25	DA	DA	DA	DESIGN
51	02/25	DA	DA	DA	DESIGN
52	02/25	DA	DA	DA	DESIGN
53	02/25	DA	DA	DA	DESIGN
54	02/25	DA	DA	DA	DESIGN
55	02/25	DA	DA	DA	DESIGN
56	02/25	DA	DA	DA	DESIGN
57	02/25	DA	DA	DA	DESIGN
58	02/25	DA	DA	DA	DESIGN
59	02/25	DA	DA	DA	DESIGN
60	02/25	DA	DA	DA	DESIGN
61	02/25	DA	DA	DA	DESIGN
62	02/25	DA	DA	DA	DESIGN
63	02/25	DA	DA	DA	DESIGN
64	02/25	DA	DA	DA	DESIGN
65	02/25	DA	DA	DA	DESIGN
66	02/25	DA	DA	DA	DESIGN
67	02/25	DA	DA	DA	DESIGN
68	02/25	DA	DA	DA	DESIGN
69	02/25	DA	DA	DA	DESIGN
70	02/25	DA	DA	DA	DESIGN
71	02/25	DA	DA	DA	DESIGN
72	02/25	DA	DA	DA	DESIGN
73	02/25	DA	DA	DA	DESIGN
74	02/25	DA	DA	DA	DESIGN
75	02/25	DA	DA	DA	DESIGN
76	02/25	DA	DA	DA	DESIGN
77	02/25	DA	DA	DA	DESIGN
78	02/25	DA	DA	DA	DESIGN
79	02/25	DA	DA	DA	DESIGN
80	02/25	DA	DA	DA	DESIGN
81	02/25	DA	DA	DA	DESIGN
82	02/25	DA	DA	DA	DESIGN
83	02/25	DA	DA	DA	DESIGN
84	02/25	DA	DA	DA	DESIGN
85	02/25	DA	DA	DA	DESIGN
86	02/25	DA	DA	DA	DESIGN
87	02/25	DA	DA	DA	DESIGN
88	02/25	DA	DA	DA	DESIGN
89	02/25	DA	DA	DA	DESIGN
90	02/25	DA	DA	DA	DESIGN
91	02/25	DA	DA	DA	DESIGN
92	02/25	DA	DA	DA	DESIGN
93	02/25	DA	DA	DA	DESIGN
94	02/25	DA	DA	DA	DESIGN
95	02/25	DA	DA	DA	DESIGN
96	02/25	DA	DA	DA	DESIGN
97	02/25	DA	DA	DA	DESIGN
98	02/25	DA	DA	DA	DESIGN
99	02/25	DA	DA	DA	DESIGN
100	02/25	DA	DA	DA	DESIGN

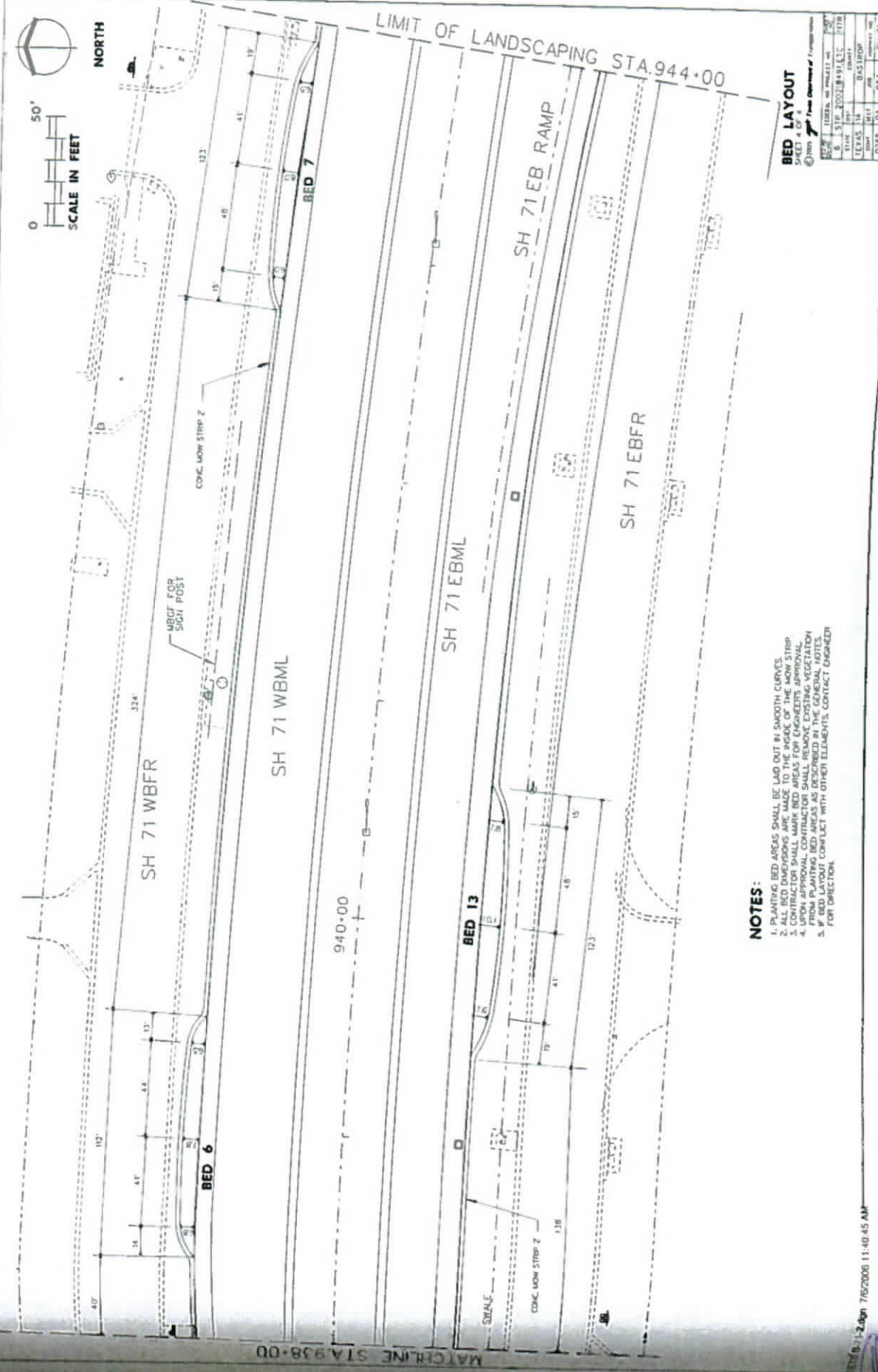

BED LAYOUT
SHEET 2 OF 2

DATE	10/20/2008	PROJECT NO.	0353
BY	STP	DESIGNED BY	STP
CHECKED BY	STP	DATE	10/20/2008
PROJECT	0353	SCALE	AS SHOWN
DRAWN BY	STP	PROJECT NO.	0353
CHECKED BY	STP	DATE	10/20/2008
PROJECT	0353	SCALE	AS SHOWN

- NOTES:**
1. PLANTING BED AREAS SHALL BE LAD OUT IN SMOOTH CURVES.
 2. ALL BED AREAS SHALL BE LAD OUT TO THE EDGE OF THE MOW STRIP.
 3. CONTRACTOR SHALL MARK BED AREAS WITH PLANTING STRIPS.
 4. UPON APPROVAL CONTRACTOR SHALL REMOVE EXISTING VEGETATION FROM PLANTING BED AREAS AS DESCRIBED IN THE GENERAL NOTES.
 5. BED LAYOUT CONFLICT WITH OTHER ELEMENTS, CONTACT ENGINEER FOR DIRECTION.

January 25, 2017

Texas Department of Transportation
Bastrop Area Office
174 Highway 21 East,
Bastrop, Texas 78602



**RE: Letter of Commitment
SH 71 Corridor Landscaping Project**

To Whom It May Concern:

As part of its support for the above-referenced project, The City of Bastrop agrees to the following:

1. Provide the engineering, labor, materials, equipment, and costs to install two 3/4" service taps and water meters at the approximate locations shown for PROJECT LOCATION A on EXHIBIT A.
2. Allow the TxDOT landscape contractor to utilize the new taps and meters at PROJECT LOCATION A, and the existing taps and meters at PROJECT LOCATION B, for the purposes of irrigating the proposed landscape project.
3. Allow the TxDOT landscape contractor to establish water usage accounts, under the name of the contractor's company, for the water meters at both project locations. The TxDOT landscape contractor will pay the City of Bastrop for the costs of water used for the duration of the contract.
4. Upon completion of the contract, the City of Bastrop will assume the responsibility for maintaining and irrigating the project. The City of Bastrop agrees to keep the plantings in an acceptable and presentable condition for the public and for the safe operations of the highway. This includes the immediate stoppage and repair of irrigation leaks, water spills, or maintenance issues that negatively impact highway safety, as well as providing an immediate response to complaints or concerns from the public.

Sincerely,

A handwritten signature in black ink, appearing to read "Marvin Townsend".

Marvin Townsend
City Manager, City of Bastrop

A handwritten signature in blue ink, located in the bottom right corner of the page.

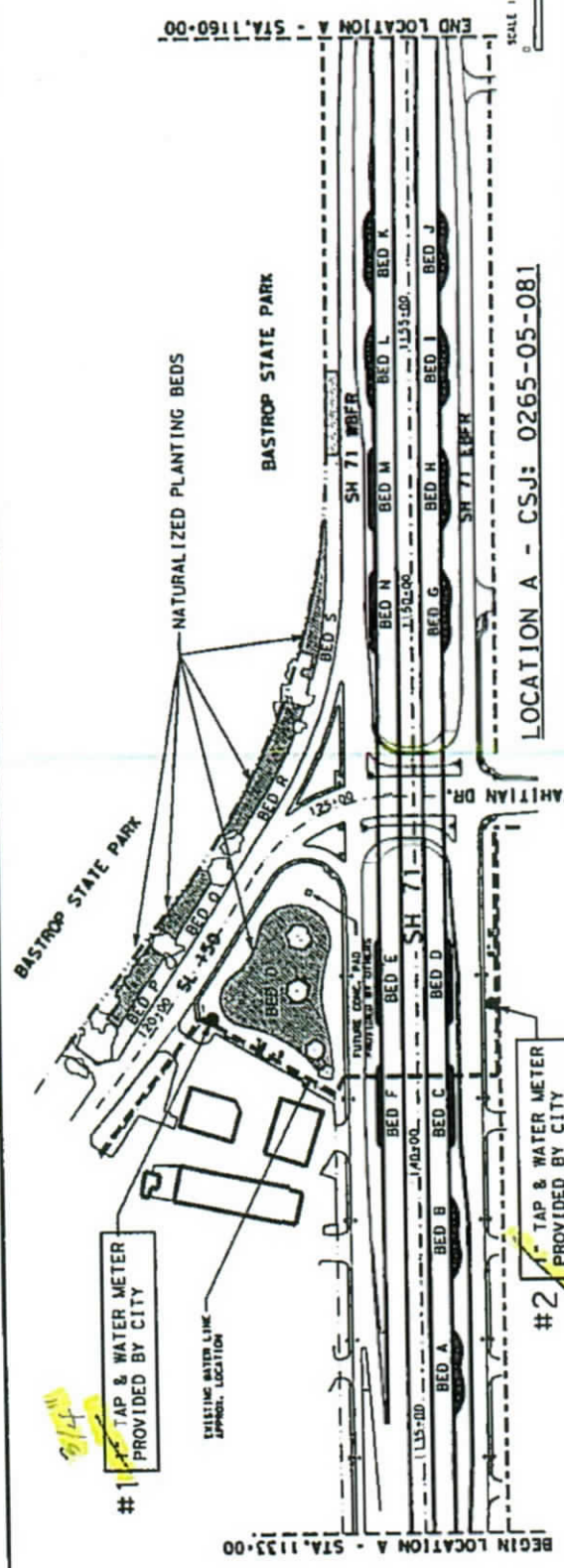

2017 TxDOT GREEN RIBBON LANDSCAPE PROJECT IN BASTROP, TX.

LOCATION A: SH 71 at SL 150 (LOOP 150) and TAHITIAN DR.

LOCATION B: SH 71 at SL 150 (LOOP 150) and CHILDERS DR.
(ALSO KNOWN AS WEST GATE)

NOTES:

- THE CITY OF BASTROP WILL PROVIDE THE ENGINEERING, LABOR, MATERIALS, EQUIPMENT, AND COSTS TO INSTALL THE 1" SERVICE TAPS AND WATER METERS AT THE APPROPRIATE LOCATIONS SHOWN ON THIS DRAWING FOR "LOCATION A."
- THE CITY OF BASTROP WILL ALLOW THE TxDOT LANDSCAPE CONTRACTOR TO UTILIZE THE NEW TAPS AND METERS AT LOCATION A AND THE EXISTING TAPS AND METERS AT LOCATION B, FOR THE PURPOSES OF IRRIGATING THE PROPOSED PLANTING AT THESE TWO LOCATIONS.
- THE CITY OF BASTROP WILL ALLOW THE TxDOT LANDSCAPE CONTRACTOR TO ESTABLISH WATER METER ACCESSORIES FOR THE WATER METERS AT LOCATION A AND LOCATION B UNDER THE NAME OF THE CONTRACTOR'S COMPANY.
- THE TxDOT LANDSCAPE CONTRACTOR WILL PAY FOR THE COSTS OF WATER USED FOR THE DURATION OF THE TxDOT LANDSCAPE CONTRACT FOR THIS PROJECT.
- THE TxDOT PROJECT WILL INCLUDE CONSTRUCTION OF THE LANDSCAPE AND IRRIGATION AS SHOWN IN THE PLANS, PLUS A 24 MONTH PLANT ESTABLISHMENT PERIOD THAT WILL INCLUDE MAINTENANCE AND IRRIGATION FOR THE PLANTING BEDS ONLY. UPON COMPLETION OF THIS PROJECT, THE CITY OF BASTROP WILL TAKE OVER THE RESPONSIBILITY OF MAINTENANCE AND IRRIGATION FOR THE PROJECT.

Austin District
Design

Texas Department of Transportation
SH 71

EXHIBIT - A
PROPOSED WATER
METER LOCATIONS

DATE	BY	APP'D	SCALE	SHEET NO.	TOTAL SHEETS
05/15/18	CSJ		1" = 200'	1	1

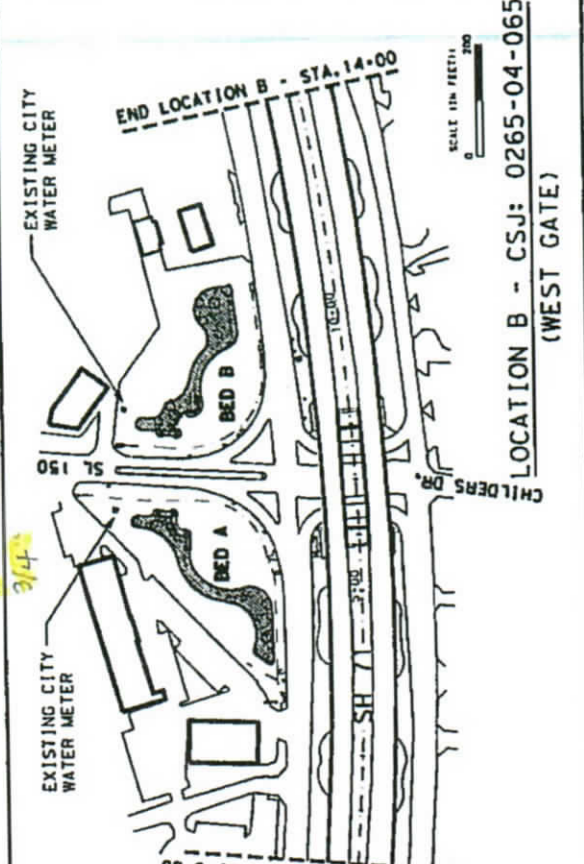

DATE: 05/15/18
BY: CSJ
APP'D: [Signature]

Project Layout /

State Highway 71 at Farm to Market 20



102925-04-054 (www.PSEVE/03-ROAD/PROJECT/1.000)
9/03/09 AM

PROJECT BENCHMARK LIST (VERTICAL ONLY)

- no. 23333-36-02: "SQUARE" CUT IN TOP OF CONCRETE HEADWALL LOCATED AT THE INTERSECTION OF SH 71 AND FM 20, NORTHSIDE OF SH 71, +/- 20 FEET NORTH OF RESTROOM EDGE OF PAVEMENT, +/- 65 FEET SOUTH OF WIRE FENCE. ELEV. 454.27'
- no. 23333-36-03: IS A RAILROAD SPIKE IN POWER POLE ON THE NORTH RIGHT-OF-WAY LINE OF SH 71, +/- 72.2 FEET OFF OF EDGE OF PAVEMENT, APPROXIMATELY 1500 FEET WEST OF FM 20. ELEV. 455.14'
- no. 23333-36-04 IS A SQUARE CUT IN TOP OF HEADWALL OF A 3' x 4' CULVERT LOCATED 7/10 MI. WEST OF THE S.H. 71 / S.H. 20 INTERSECTION, BEING 52.2 FEET NORTHEAST OF A POWER POLE, 14 FEET SOUTH OF THE S.H. 71 SOUTH FRONTAGE EDGE OF PAVEMENT, AND 65.4 FEET EAST OF A GRAVEL DRIVE. ELEV. 451.47'

POINT #	Y	X	Z	DESCRIPTION
6010	10016730.80	3233302.80	449.37	TPI1/2SET/5M/CAP
6011	10016698.89	3232433.86	456.24	TPI1/2SET/5M/CAP
6012	10016660.25	3231454.26	456.83	TPI1/2SET/5M/CAP
6013	10016633.84	3230718.38	455.61	TPI1/2SET/5M/CAP
6014	10016622.81	3229899.75	456.47	TPI1/2SET/5M/CAP
6015	10016499.78	3230033.71	452.07	TPI1/2SET/5M/CAP
6016	10016451.30	3230815.06	456.05	TPI1/2SET/5M/CAP
6017	10016489.11	3231779.77	457.20	TPI1/2SET/5M/CAP
6018	10016547.11	3232598.57	455.48	TPI1/2SET/5M/CAP
6019	10016569.76	3233414.66	447.16	TPI1/2SET/5M/CAP
6025	10016093.40	3232592.28	471.87	TPI1/2SET/5M/CAP
10000	10016093.27	3231812.91	457.38	TPI1/2SET/5M/CAP
10001	10016634.36	3232592.21	455.50	TPI1/2SET/5M/CAP

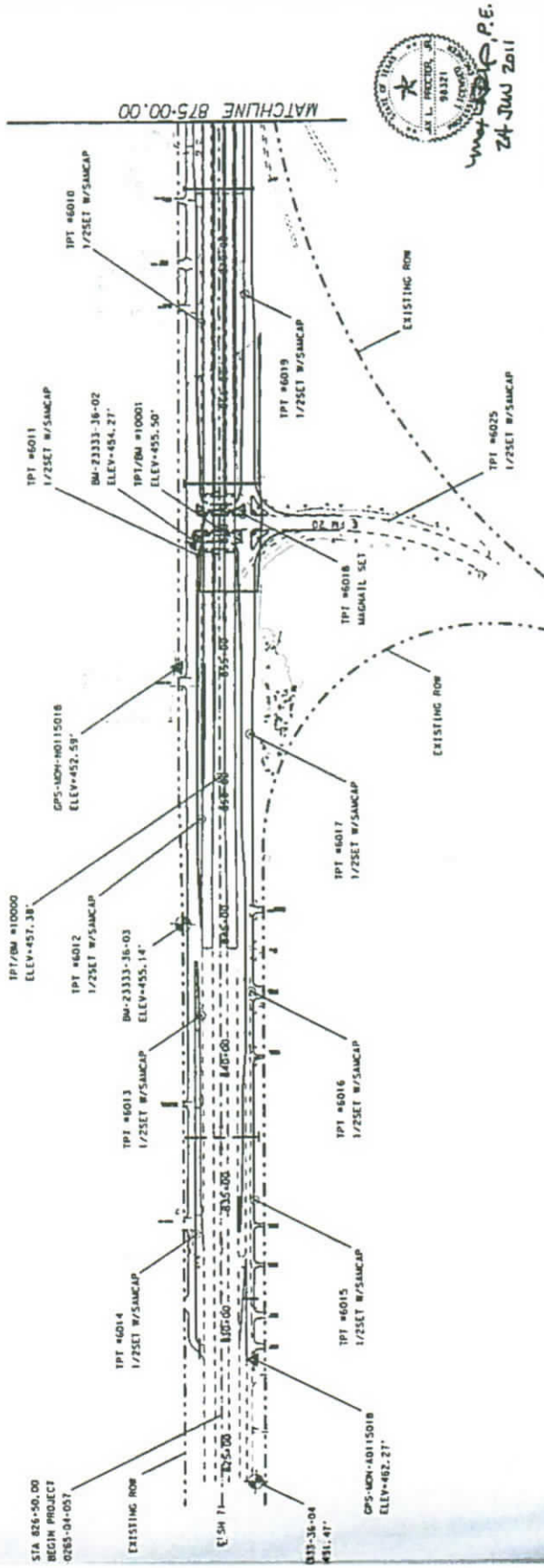

PROJECT LAYOUT

SHEET 1 OF 2
STA 823+00 TO STA 875+00

DATE: 24 JUN 2011
BY: [Signature]

SCALE: 0 100 200 300 400 FT

ALL PROJECT COORDINATES ARE BASED ON THE TEXAS STATE PLANE COORDINATE SYSTEM, CENTRAL ZONE, MAD 83 (1993). ALL COORDINATES HAVE BEEN ADJUSTED TO SURFACE BY A COMBINED ADJUSTMENT FACTOR OF 1.00001.

VERTICAL DATUM - NAVD83
UNITS - U.S. SURVEY FEET

DATE	BY	SHEET NO.
02/25/04	057, BTC	21
02/21/09	057, BTC	22
AUG	BASTROP	3

102925-04-054 (www.PSEVE/03-ROAD/PROJECT/1.000)
9/03/09 AM

0285-04-05 REVISED 10/11/03 10/11/03 PROJECT 12.00P
9/04/31 AM

OBJECT BENCHMARK LIST - VERTICAL ONE, 1/1

N. 23333-36-011 "SQUARE" CUT IN CONCRETE DRIVEWAY FOR BLUEBONNET
ELECTRIC COMPANY, NORTH SIDE OF FM 71, +/- 3500 FEET EAST OF FM 20, +/- 3200
FEET WEST OF FM 969.
ELEV. 445.15'

SECONDARY CONTROL POINTS - SURFACE COORDINATES

POINT #	Y	X	Z	DESCRIPTION
5000	10016743.62	3235355.09	415.39	TP1: COI-SPIN SET/STA-888-00
6006	10016822.28	3235280.83	417.74	TP1: 1/2SET/SA/CA/P
6008	10016191.86	3234764.07	437.82	TP1: 1/2SET/SA/CA/P
6009	10016162.46	3234095.65	445.94	TP1: 1/2SET/SA/CA/P
6020	10016545.55	3234143.10	442.02	TP1: 1/2SET/SA/CA/P
6021	10016630.34	3234705.20	443.27	TP1: 1/2SET/SA/CA/P
6022	10016600.07	3235383.22	409.88	TP1: 1/2SET/SA/CA/P
6023	10017439.42	3235116.26	412.65	TP1: 1/2SET/SA/CA/P
10002	10016697.27	3234161.39	445.36	TP1: COI-SPIN SET/STA-816-06

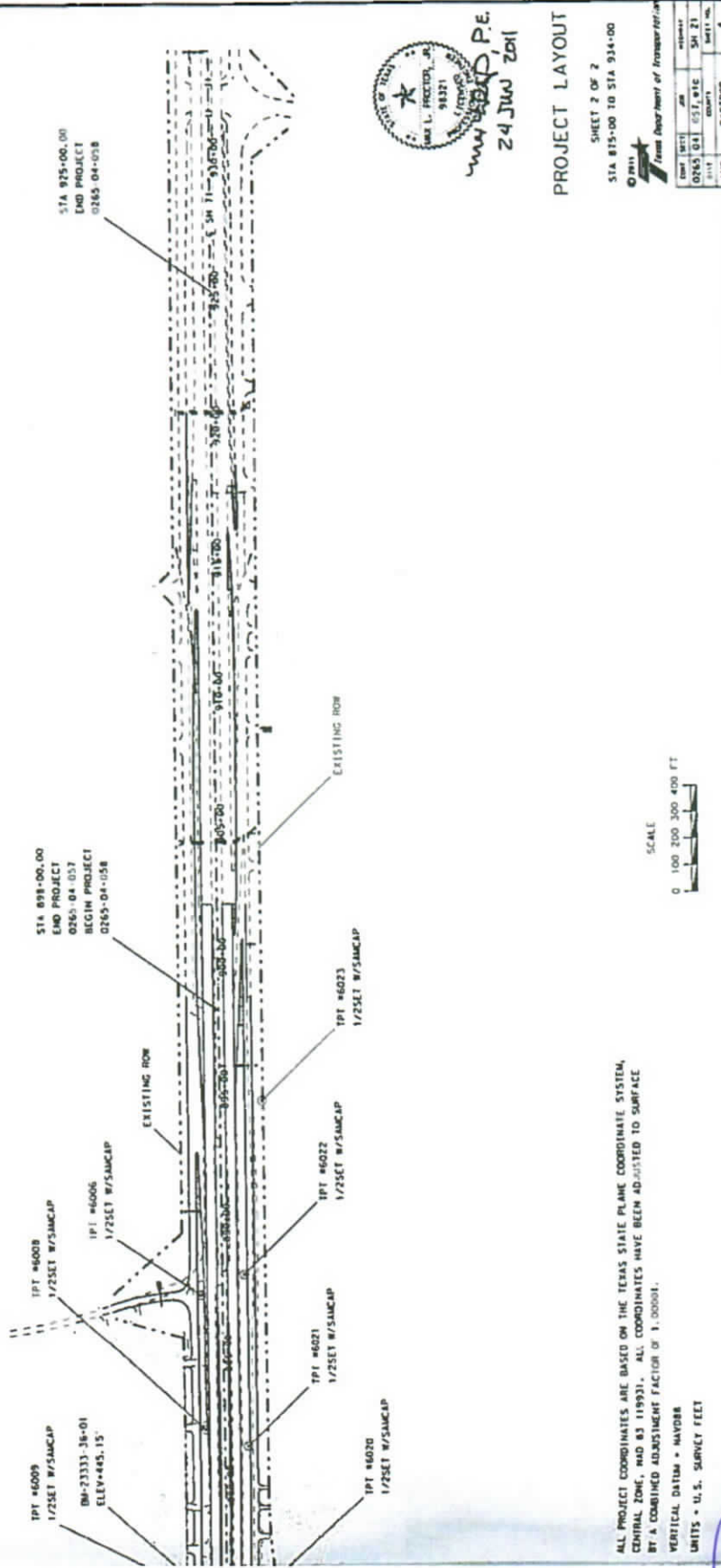

Wm L. Proctor, P.E.
24 JUN 2011

PROJECT LAYOUT
SHEET 2 OF 2
STA 815+00 TO STA 934+00
END PROJECT
0285-04-05B
Texas Department of Transportation
AUG 2011

ALL PROJECT COORDINATES ARE BASED ON THE TEXAS STATE PLANE COORDINATE SYSTEM, CENTRAL ZONE, NAD 83 (1993). ALL COORDINATES HAVE BEEN ADJUSTED TO SURFACE BY A COMBINED ADJUSTMENT FACTOR OF 1.00001.

VERTICAL DATUM = NAVD83
UNITS = U.S. SURVEY FEET

[Handwritten signature]

Project Layout /

State Highway 71 at Lp 150 / Tahitian Drive



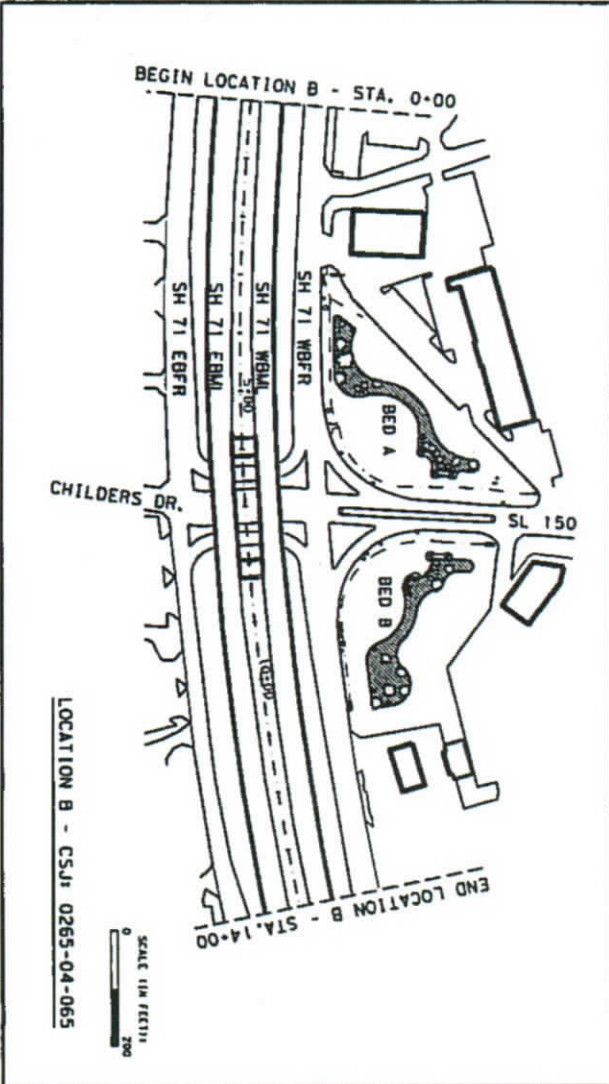

LOCATION B - CSJ: 0265-04-065

- SITE CONDITIONS AND MEASUREMENTS**
- BE ADVISED THAT DITCHES, SWALES, SLOPES, IMPROVEMENTS, AND OTHER POTENTIAL CONFLICTS MAY NOT BE SHOWN ON THE PLAN. EXAMINE THE SITE PRIOR TO CONSTRUCTION AND REPORT AREAS OF POTENTIAL EROSION AND OTHER CONFLICTS, FOR DIRECTION, PLACE, EMISSION CONTROL, DEVICES AND ROADWAY BED LOCATIONS, AS DIRECTED.
 - RED LAYOUT DIMENSIONS ARE MEASURED FROM FACE OF CURB, UNLESS SHOWN OTHERWISE. LAYOUT BEDS BEFORE EMULCATING TURF TO ENSURE THAT BEDS ARE PLACED TO MINIMIZE POTENTIAL EROSION AND RUNOFF.
- TREE PROTECTION**
- REFER TO TRD-16 AND TREE PROTECTION DETAILS SHEET
- PRIOR TO CONSTRUCTION PROVIDE AND SECURELY INSTALL SAFETY FENCING TO PROTECT THE CRITICAL ROOT ZONE FOR EACH TREE MEASURED AT 1 FOOT DISTANCE FROM TRUNK FOR EVERY 1 INCH OF TRUNK DIAMETER.
 - DO NOT ALLOW THE FOLLOWING ACCESS, ACTIVITIES OR STORAGE WITHIN TREE PROTECTION FENCING:
 - (A) MACHINERY, EQUIPMENT OR MATERIALS STORAGE;
 - (B) MEDICINAL, TOXIC OR IRRITATING; OR
 - (C) HAZARDOUS CHEMICALS, PRODUCTS, AND THEIR CONTAINERS.
 - PROTECT THE FOLLOWING ACTIVITIES AFTER PLANT BEDS ARE PREPARED:
 - (A) TREE PROTECTION FENCING;
 - (B) DO NOT TALK OR INAPPROPRIATE CONDUCT;
 - (C) SWALES IN ROOT ZONE, POCKET PLANT, ONLY;
 - (D) DO NOT CUT ROOTS 1 INCH DIAM OR GREATER;
 - (E) PREPARE WITH CARE, TUBES SECURED TO GROUND, DO NOT STAKE;
 - (F) APPLY MULCH AT SPECIFIED DEPTH TO CONFIN SOIL TUBING.
4. ACTUAL LOCATION OF EXISTING TREES MAY BE DIFFERENT THAN SHOWN. EXAMINE SITE TO DETERMINE ACTUAL LOCATION OF EXISTING TREES. REPORT ALL DISCREPANCIES OR CONFLICTS FOR DIRECTION.

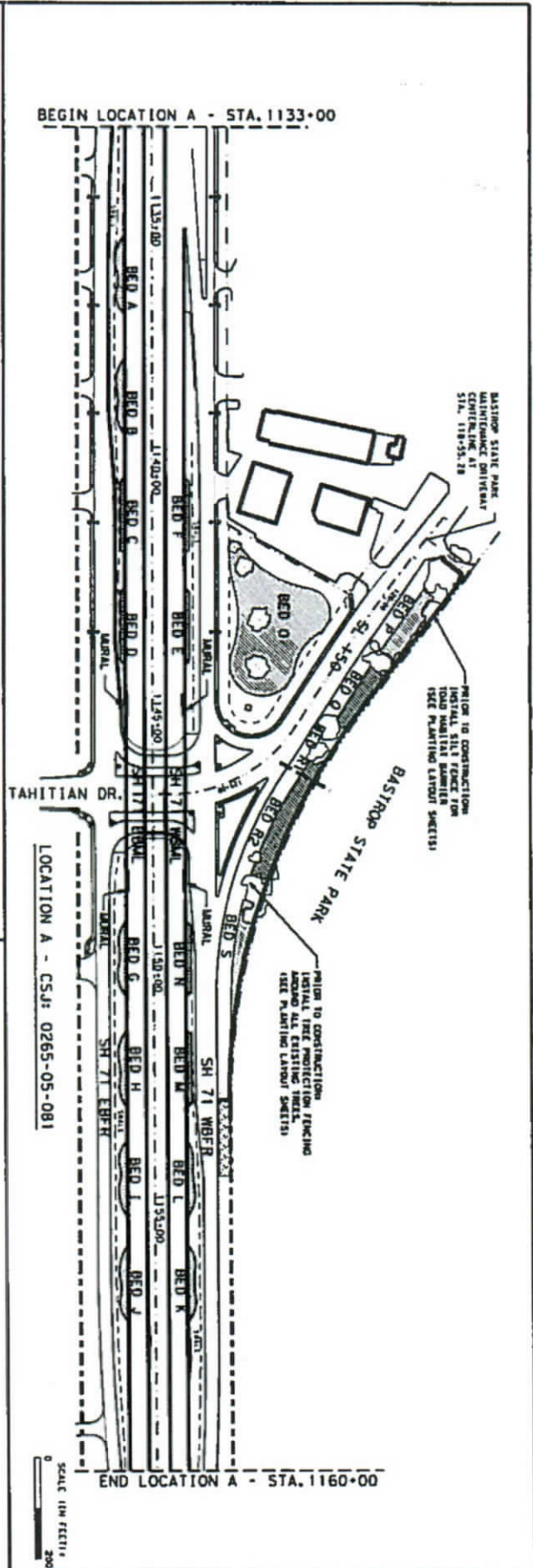

LOCATION A - CSJ: 0265-05-081

2/27/2017



2/27/2017

Austin District
Design

Texas Department of Transportation
SH 71
SITE PLAN
LOCATION A & B

DATE	02/26/05	BY	081/ELC
FILE	0265-04-065	BY	081/ELC
DATE	02/26/05	BY	081/ELC
FILE	0265-04-065	BY	081/ELC

SHEET 1 OF 2

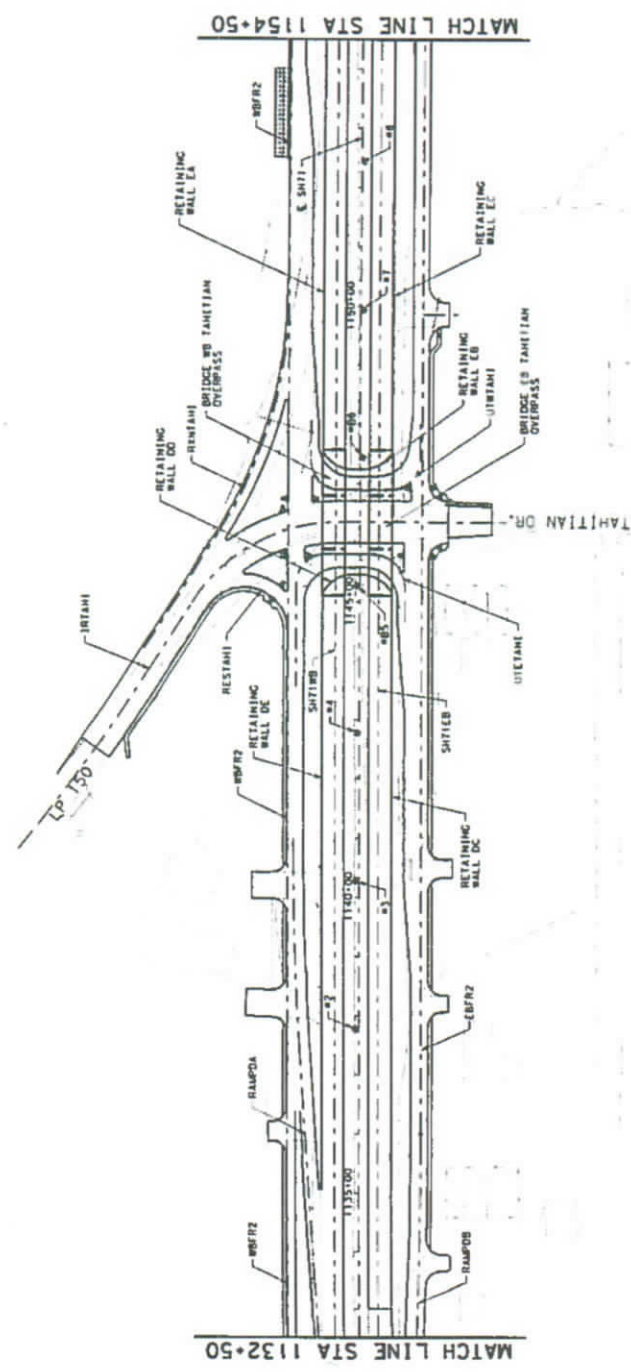
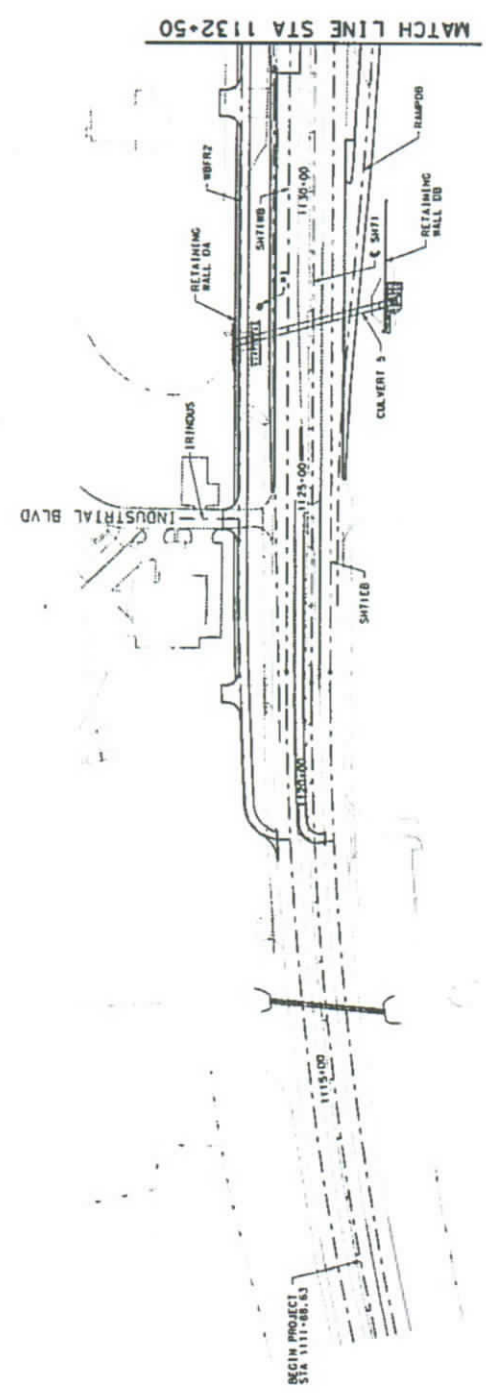

9 BOREHOLE LOCATIONS

James B. Langston
No. 72891
State of Nevada
License in Civil Engineering

Year of Incorporation: 1989

INCORPORATED 3 ASSOCIATES, INC.
1000 W. HARRIS BLVD., SUITE 100
LAS VEGAS, NV 89102

Scale: 1" = 100'

S. H. 71
PROJECT
LAYOUT

SHEET 1 OF 2	
DATE	11/11/14
DESIGNED BY	WJL
CHECKED BY	WJL
DATE	11/11/14
PROJECT	S.H. 71
DATE	11/11/14
PROJECT	S.H. 71

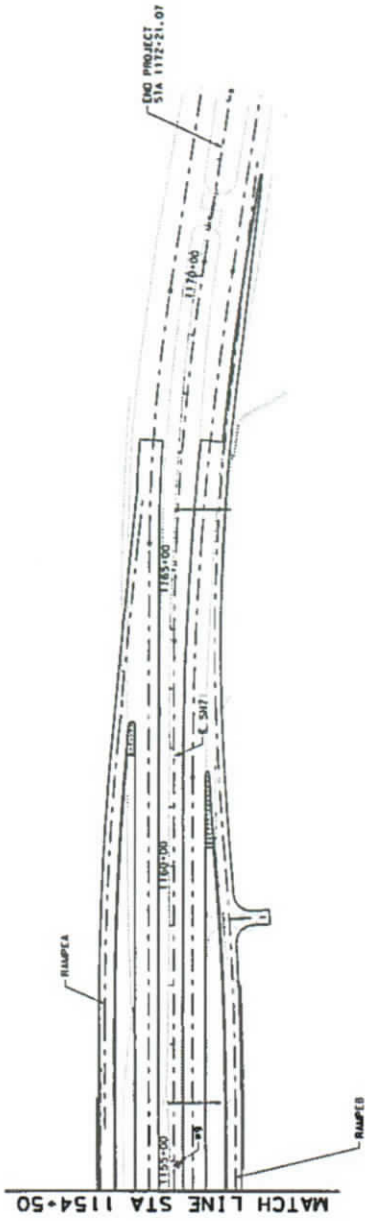

• BOREHOLE LOCATIONS



James H. Langston
 State of Texas
 License No. 71891

James H. Langston & Associates, Inc.
 1101 Commerce Street, Suite 1000
 Dallas, Texas 75202

State Department of Transportation
 PROJECT NO. 2012-14371
 SHEET NO. 71

SHEET 2 OF 2

PROJECT NO.	2012-14371
DATE	07/15/14
DESIGNER	JHL
CHECKER	JHL
DATE	07/15/14

Project Layout /
Landscaping Layout

State Highway 71 at
Hasler Blvd and Lp 150



INTERSECTION OF
SH 71 AND SH 304

CP 1
ELEVATION - 281.17
ELEVATION - 281.17
ELEVATION - 281.17
ELEVATION - 281.17

INTERSECTION OF
SH 71 AND HASLER BLVD

NOTES: COORDINATES AND BEARINGS ARE STATE PLANE
CONVERSIONS. STATION POINTS AND DISTANCES
ARE TO BE ADJUSTED BY A FACTOR OF 1.00004.

INTERSECTION OF
SH 71 AND LP 150 WEST

CP 2
ELEVATION - 281.17
ELEVATION - 281.17
ELEVATION - 281.17
ELEVATION - 281.17

COLORADO RIVER BRIDGE



John M. Reeves
JOHN M. REEVES, P.E.
04-19-03
DATE

STATE HIGHWAY 71
PROJECT LAYOUT

PL. 1, 1.

DATE	2003	04	04	DATE	04/19/03
PROJECT NO.	200218470	DATE	04/19/03	DATE	04/19/03
BY	JMR	DATE	04/19/03	DATE	04/19/03
CHECKED	JMR	DATE	04/19/03	DATE	04/19/03
DATE	04/19/03	DATE	04/19/03	DATE	04/19/03

(STA 984+31.84)

MATCHLINE A

HASLER BLVD

NORTH

APPROX 35' OF SLEEVE ON BORE

STONE PLANTER

APPROX 60' OF SLEEVE ON BORE

CONC. MOW STRIP

PLANTING BED

W. B. FRONTAGE RD.

W. B. MAINLANES

980+00

SH 71

E. B. MAINLANES

PLANTING BED

CONC. MOW STRIP

STONE PLANTER

APPROX 30' OF SLEEVE ON BORE

FLOW

APPROX 60' OF SLEEVE ON BORE

PLANTING BED

E. B. FRONTAGE RD.

(STA 978+35)

BEGINNING STATION FOR LANDSCAPE PLANTING

IRRIGATION LAYOUT
SHEET 1 OF 3
DESIGNED BY: [Signature]
DATE: 1/14/11
PROJECT: [Signature]
SCALE: AS SHOWN
DATE: 1/14/11
DRAWN BY: [Signature]
CHECKED BY: [Signature]
DATE: 1/14/11
APPROVED BY: [Signature]
DATE: 1/14/11



3/27/09
STATE OF TEXAS
PROFESSIONAL ENGINEER
LICENSE NO. 1251
DATE 3/27/09

W. B. FRONTAGE RD.
W. B. MAINLANES
SH 71
E. B. MAINLANES
E. B. FRONTAGE RD.

PLANTING BED
CONC. MOW STRIP
STONE PLANTER
APPROX 30' OF SLEEVE ON BORE
APPROX 60' OF SLEEVE ON BORE
FLOW

PLANTING BED
CONC. MOW STRIP
STONE PLANTER
APPROX 30' OF SLEEVE ON BORE
APPROX 60' OF SLEEVE ON BORE
FLOW

PLANTING BED
CONC. MOW STRIP
STONE PLANTER
APPROX 30' OF SLEEVE ON BORE
APPROX 60' OF SLEEVE ON BORE
FLOW

PLANTING BED
CONC. MOW STRIP
STONE PLANTER
APPROX 30' OF SLEEVE ON BORE
APPROX 60' OF SLEEVE ON BORE
FLOW

PLANTING BED
CONC. MOW STRIP
STONE PLANTER
APPROX 30' OF SLEEVE ON BORE
APPROX 60' OF SLEEVE ON BORE
FLOW

LEGEND
[Symbol] WATER METER SUPPLIED BY CITY
[Symbol] QUICK COUPLER
[Symbol] DRIP VALVE ASSEMBLY
[Symbol] SLEEVE ON BORE
[Symbol] CITY WATER MAIN
[Symbol] MAIN LINE
[Symbol] LATERAL LINE
[Symbol] DRIP LINE TIEING
SCALE IN FEET
0 50'

NOTES
1. ALL PIPE BETWEEN THE WATER METER AND THE VALVE SHALL BE 1" SCH. 40 PVC.
2. PIPE DOWNSTREAM OF THE VALVES SHALL BE 1/2" SCH. 40 PVC.

[Handwritten Signature]

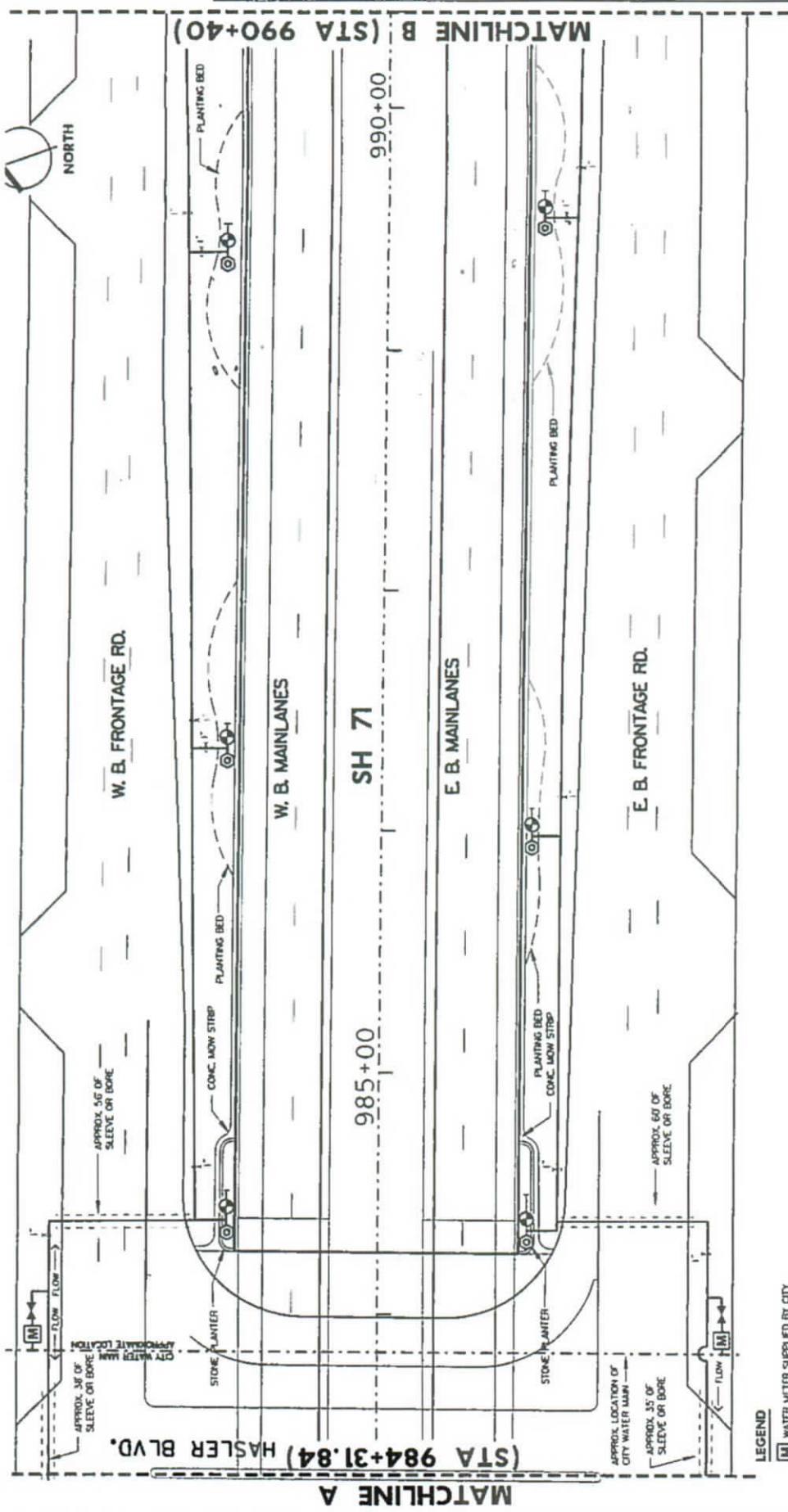

IRRIGATION LAYOUT
 SHEET 2 OF 2
 (Check for Field Department of Transportation)

DATE	2/12/04
DESIGNER	STEVEN B. BUCKLETT
CHECKED	12/23
SCALE	AS SHOWN
PROJECT NO.	0285
SHEET NO.	04
DATE	04/17/04
SH	71

- LEGEND**
- WATER METER SUPPLIED BY CITY
 - QUICK COMPLEX
 - DRPP VALVE ASSEMBLY
 - SLEEVE OR BORE
 - CITY WATER MAIN
 - MAIN LINE
 - LATERAL LINE
 - DRP LINE TUBING
- 0 50' SCALE IN FEET

[Handwritten signature]

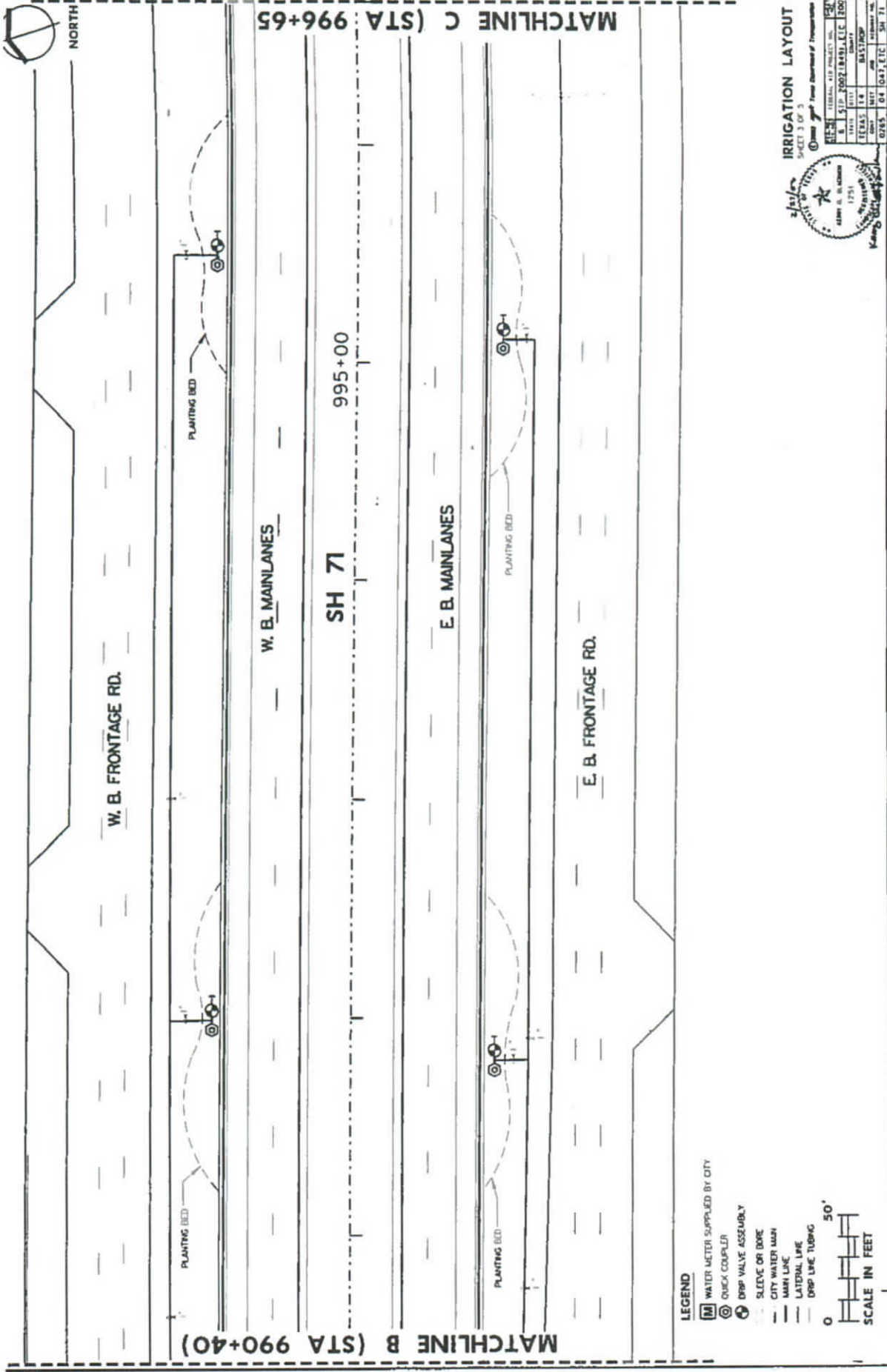

NORTH

W. B. FRONTAGE RD.

PLANTING BED

W. B. MAINLANES

SH 71 995+00

E. B. MAINLANES

PLANTING BED

E. B. FRONTAGE RD.

MATCHLINE B (STA 990+40)

MATCHLINE C (STA 996+65)

- LEGEND**
- [M] WATER METER SUPPLIED BY CITY
 - [C] QUICK COUPLER
 - [V] DRIP VALVE ASSEMBLY
 - SLEEVE OR DORE
 - - - CITY WATER MAIN
 - - - MAIN LINE
 - - - LATERAL LINE
 - - - DRIP LINE TUBING
- 0 50' SCALE IN FEET

IRRIGATION LAYOUT
SHEET 3 OF 3

DESIGNED BY: *[Signature]*
DRAWN BY: *[Signature]*

DATE	07/85
BY	04
CHKD	04
APP'D	04
DATE	04/7
BY	04
CHKD	04
APP'D	04

STATE OF TEXAS
COUNTY OF DALLAS
CITY OF DALLAS
DEPARTMENT OF PUBLIC WORKS
DIVISION OF WATER UTILITIES

[Handwritten signature]

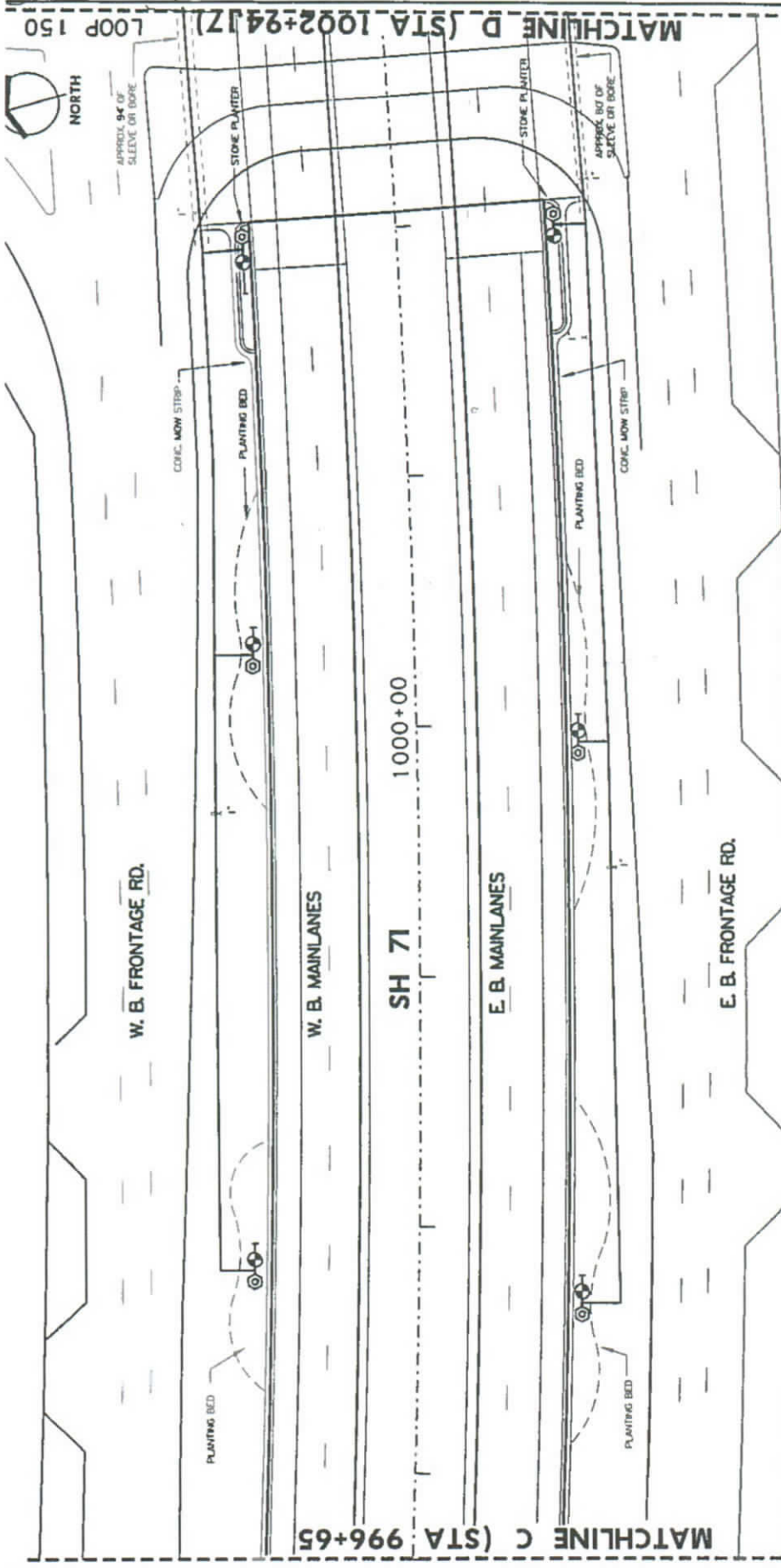

- LEGEND**
- WATER METER SUPPLIED BY CITY
 - QUICK COMPLEX
 - DRIP VALVE ASSEMBLY
 - SLEEVE OR LODGE
 - CITY WATER MAIN
 - MAIN LINE
 - LATERAL LINE
 - DRIP LINE TUBING
- 0 50' SCALE IN FEET

IRRIGATION LAYOUT
SHEET 4 OF 5

2/12/09

STATE OF TEXAS
COUNTY OF BASTROP

DATE: 02/12/09
SCALE: 1" = 50'

PROJECT: SH 71

DESIGNER: [Signature]

CHECKED: [Signature]

APPROVED: [Signature]

PROJECT NO.: 08-1002-18-01-1-01

DATE: 02/12/09

SCALE: 1" = 50'

[Handwritten signature]

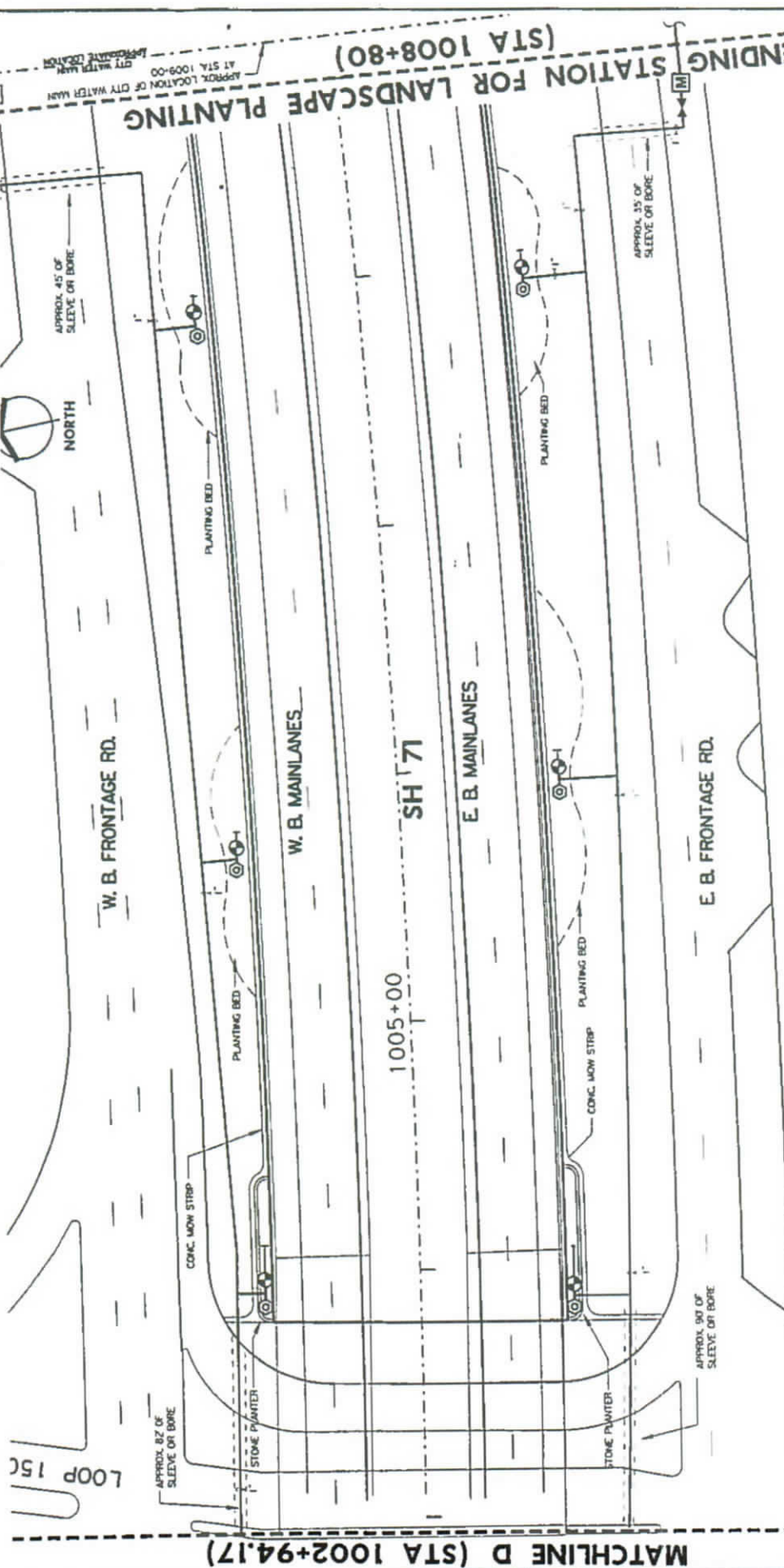

LEGEND

- WATER METER SUPPLIED BY CITY
- QUICK COUPLER
- DRP VALVE ASSEMBLY
- SLEEVE OR BORE
- CITY WATER MAIN
- MAIN LINE
- LATERAL LINE
- DRP LINE TUBING

SCALE IN FEET

0 50'

IRRIGATION LAYOUT
SHEET 5 OF 5

Checked by: [Signature]
Date: [Date]

DATE	BY	REVISION
04/04/11	SH 71	01
04/04/11	SH 71	02
04/04/11	SH 71	03
04/04/11	SH 71	04
04/04/11	SH 71	05

APPROX. LOCATION OF CITY WATER MAIN AT STA. 1009+00

APPROX. LOCATION OF CITY WATER MAIN AT STA. 1008+80

[Handwritten signature]

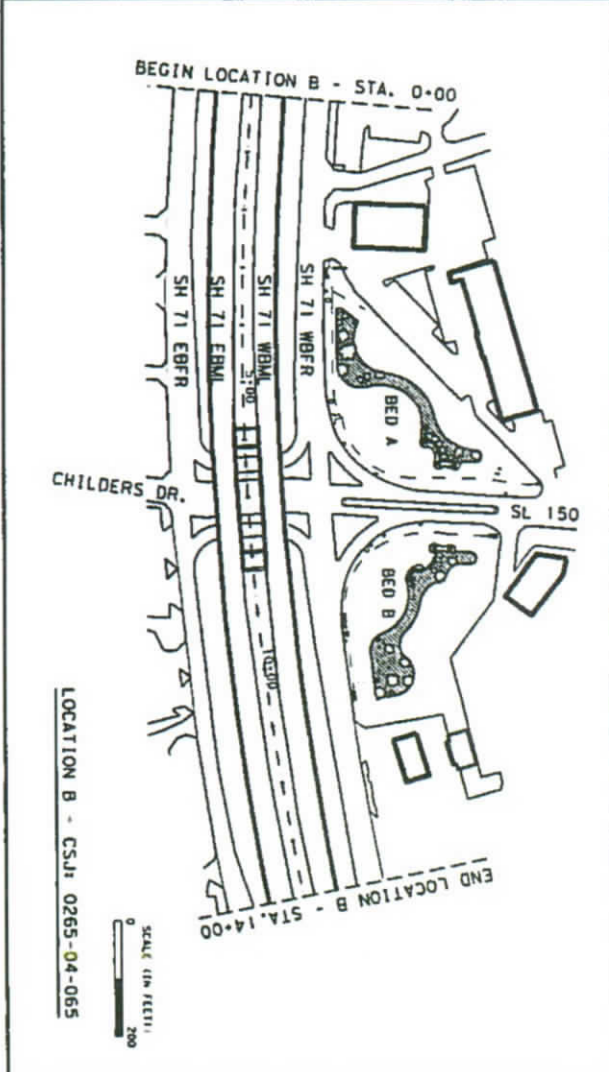

LOCATION B - CSJ: 0265-04-065

SCALE (IN FEET):
 0 200

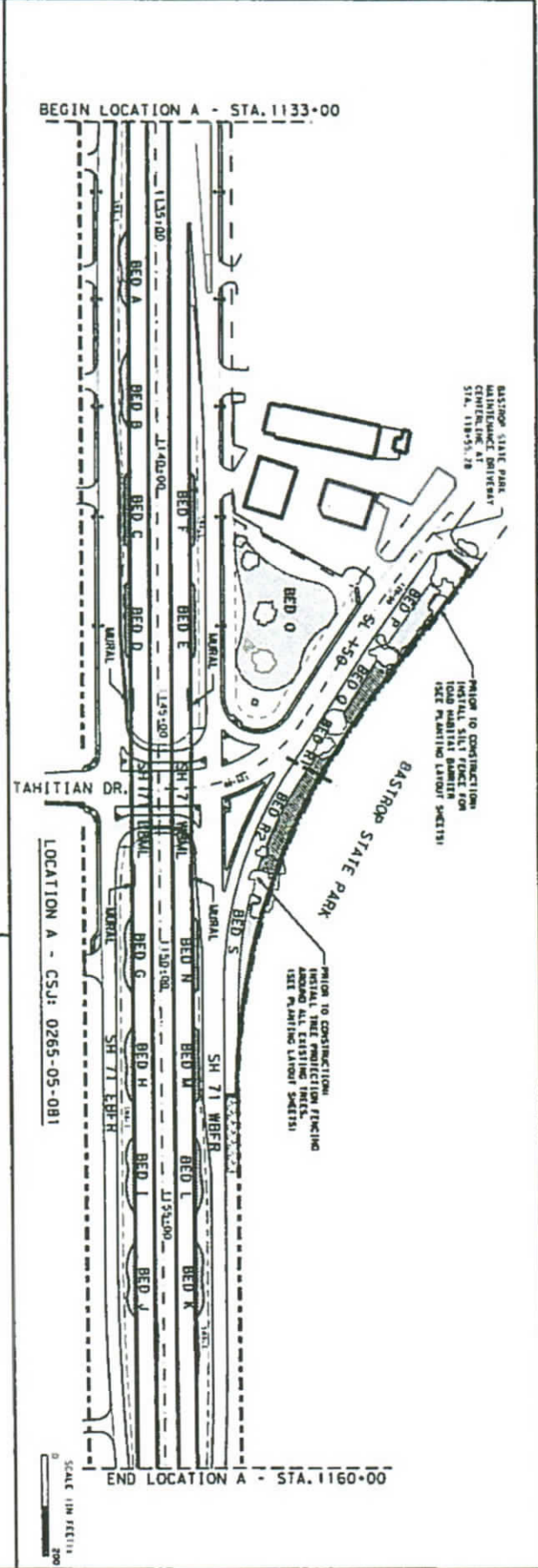

LOCATION A - CSJ: 0265-05-081

SCALE (IN FEET):
 0 200

SITE CONDITIONS AND MEASUREMENTS

- BE ADVISED THAT UTILITIES, TRAILS, LOGS, APPURTENANCES, AND OTHER POTENTIAL CONFLICTS MAY NOT BE SHOWN ON THE PLANS. EXAMINE THE SITE PRIOR TO CONSTRUCTION AND REPORT AREAS OF POTENTIAL EROSION AND OTHER CONFLICTS, FOR DIRECTION, PLACE EROSION CONTROL DEVICES AND ADDRESS BED LOCATIONS, AS DIRECTED.
- BED LAYOUT DIRECTIONS ARE MEASURED FROM BACK OF CURB, UNLESS SHOWN OTHERWISE. LAYOUT BEGS BEFORE ESTABLISHING TURN TO ENSURE THAT BEGS ARE PLACED TO MINIMIZE POTENTIAL EROSION AND MISROUT.

TREE PROTECTION

REFER TO PRO-16 AND TREE PROTECTION DETAILS SHEET

- PRIOR TO CONSTRUCTION PROVIDE AND SECURELY MAINTAIN SAFETY FENCING AROUND THE TREE PROTECTION PERIMETER. TREE PROTECTION SHALL BE MEASURED AT 1 FOOT DISTANCE FROM TRUNK FOR EVERY 1 INCH OF TRUNK DIAMETER.
- DO NOT TAKE THE FOLLOWING ACCESS, ACTIVITIES OR STORAGE WITHIN TREE PROTECTION PERIMETER:
 - VEHICLES, EQUIPMENT, OR MATERIAL STORAGE
 - MATERIALS, CHEMICALS, PRODUCTS, AND THEIR CONTAINERS
- PROVIDE THE FOLLOWING ACTIVITIES AFTER PLANT BEDS ARE PREPARED:
 - DO NOT TALK OR ACCOMPANY THE CONTRACTOR.
 - DO NOT CUT ROOTS IN ROOT ZONE, POCKET PLANT, ONLY.
 - DO NOT CUT ROOTS IN ROOT ZONE OR GREATER.
 - RELOCATE WITH CARE. TUBING SECURED TO GROUND, DO NOT IN ANY WAY WHICH AT VERTICAL DEPTH TO COVER DEEP TUBING.

ACTUAL LOCATIONS OF EXISTING TREES MAY BE DIFFERENT THAN SHOWN. EXAMINE SITE TO DETERMINE ACTUAL LOCATIONS OF EXISTING TREES. REPORT ANY DISCREPANCIES ON COMPLETION FOR DIRECTION.

Austin District
 Design

Texas Department of Transportation

SH 71
 SITE PLAN
 LOCATION A & B

SHEET 1 OF 2

DATE	BY	CHKD	APP'D
04/11/17	0181, 051, 081, ETC.	SH 71	
04/11/17	0265-04-065	0265-05-081	0265-05-081



[Handwritten signature]

Project Layout

State Highway 71 at State Highway 95



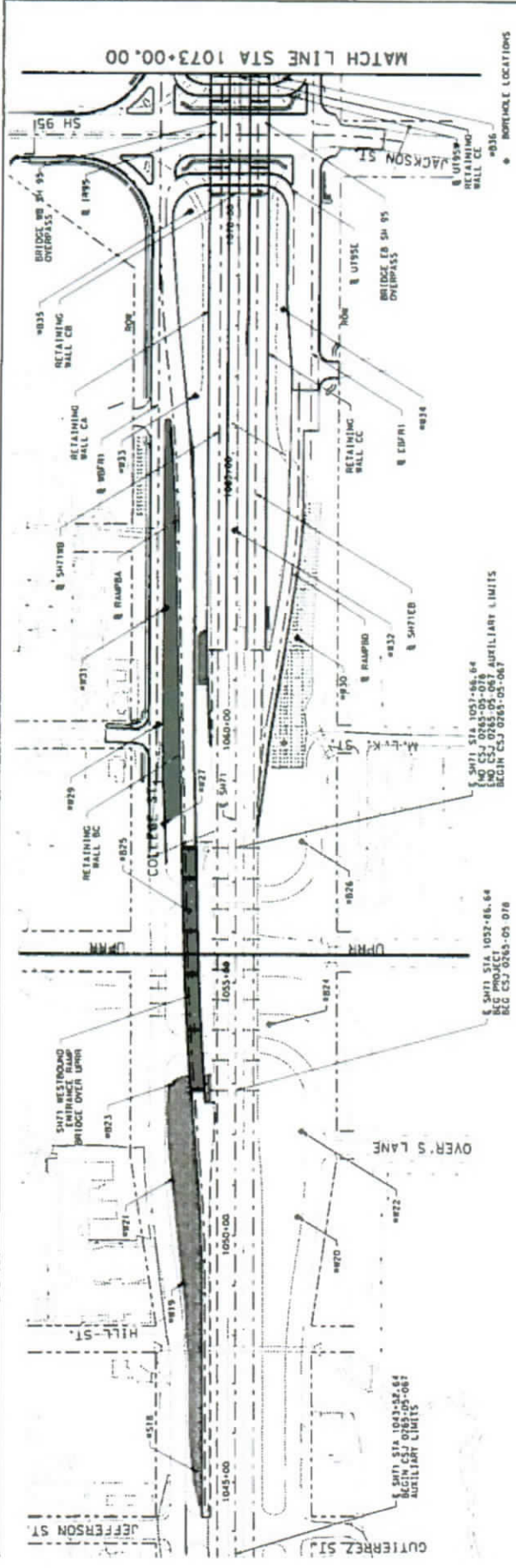

S.H. 71
PROJECT
LAYOUT
SHEET

Scale: 1" = 100'

DATE: 11/27/2017

PROJECT NO. 1043+52.64

DATE: 11/27/2017

PROJECT NO. 1043+52.64

DATE: 11/27/2017

PROJECT NO. 1043+52.64

SHEET 1 OF 1

DATE	11/27/2017	PROJECT NO.	1043+52.64
DATE	11/27/2017	PROJECT NO.	1043+52.64
DATE	11/27/2017	PROJECT NO.	1043+52.64
DATE	11/27/2017	PROJECT NO.	1043+52.64
DATE	11/27/2017	PROJECT NO.	1043+52.64
DATE	11/27/2017	PROJECT NO.	1043+52.64

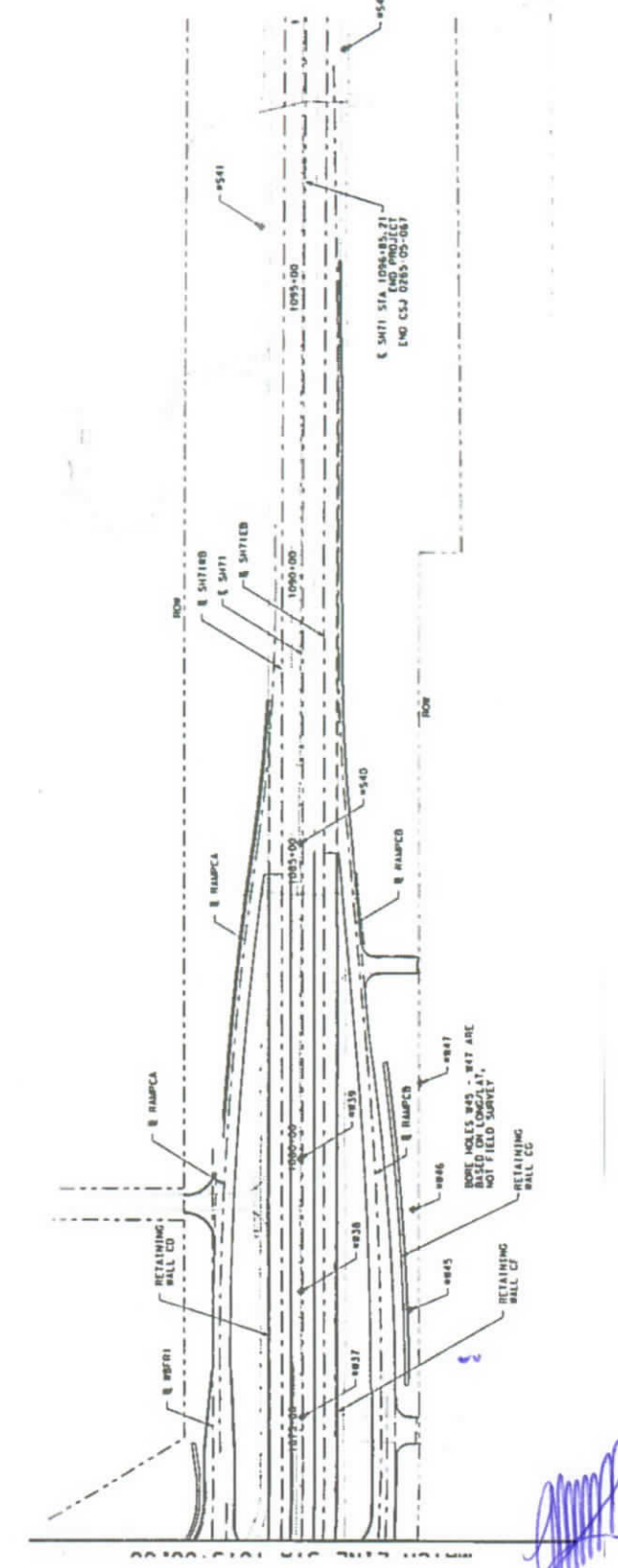

[Handwritten signature]